



SEABOATS

MARINE BROKERS WITH A GLOBAL APPROACH

AUSTRALIA - BULGARIA - INDIA - INDONESIA - ITALY - MALAYSIA - NEW ZEALAND - PANAMA - PHILIPPINES - SINGAPORE - SPAIN - UK - USA - VENEZUELA - VIETNAM

sales@seaboats.net - www.seaboats.net

175ft Fast Supply Vessel

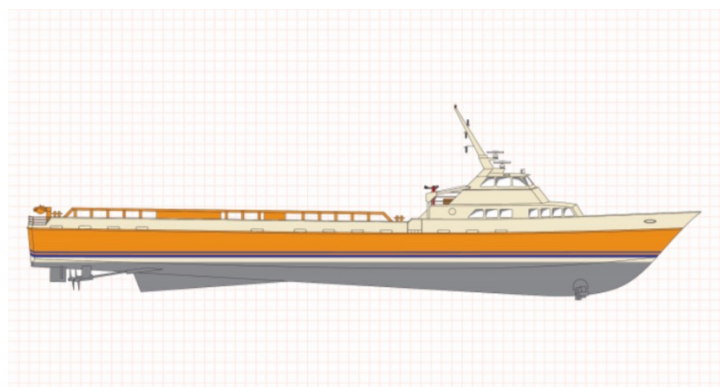

Listing ID - 1380

Description 175ft Fast Supply Vessel

Date 1998

Launched

Length 50.29m

Beam 9.75m

Draft 3.96m

Location USA

Broker John Kearns
john.kearns@seaboatsbrokers.com
+64 21 400 805

Hull: 36

Vessel Type: Fast Supply Vessel

Year Built: 1998

Shipyard: Breaux Brothers Enterprises

DIMENSIONS

LOA: 50.29m

Beam: 9.75m

Draft: 3.96m

Draft (Maximum Operations): 9 ft (2.74m)

Freeboard (Maximum Draft): 6 ft (1.83 m)

Clear Deck: 106 ft. x 28 ft. (29.26 m x 8.53 m)

Cargo Deck Area: 2,968 sq. ft. (249.59 m2)

Deck Cargo Capacity: 300 LT (304.81 MT)

Gross Tonnage: 98 (88.9 MT)

Net Tonnage: 67 (60.78 MT)

Deadweight Tonnage: 500 LT (508.02 MT)

CAPACITIES

Fuel Oil: 20,263 gals. (76.70 m³)

Ballast: 35,019 gals. (132.56 m³)

Potable Water: 1,066 gals. (4.04 m³)

PUMPS WITH DISCHARGE RATES

Fuel Oil: 190 GPM @ 140 ft.

Water: 190 GPM @ 140 ft.

MACHINERY

Main Engines: Three (3) 3516B Twin Speed, 6,600 BHP

Auxiliary Engine: One (1) CAT C9, 503 BHP

Bow Thrusters; One (1) 150 HP Retractable Azimuthing

Bow Thrusters: Thrustmaster TT 200 HP tunnel thrusters

Stern Thrusters: Thrustmaster TT 200 HP tunnel thrusters

Speed: 22 knots

Propellers: Three (3) 68" x 76" Fixed/Open

Generators; Two (2) CAT 3406; 75 kW each

SPECIAL FEATURES

Ship Motion: Roll Stabilization Tanks

Positioning: DP 2

Walk-In Cooler

Walk-In Freezer

ELECTRONICS

Electronics Package

Two (2) Radars

Two (2) VHF Radios

Sea SBB (Single Sideband Radio)

Depth Sounder

GPS

Navtex Receiver

Necoder

Autopilot

406 EPIRB

MT V-Sat

CLASSIFICATION

ABS: High-Speed Regulations

ABS: Loadline

ABS: A1

ABS: AMS

ACCOMMODATIONS

Accommodations: 7

Passengers: 65

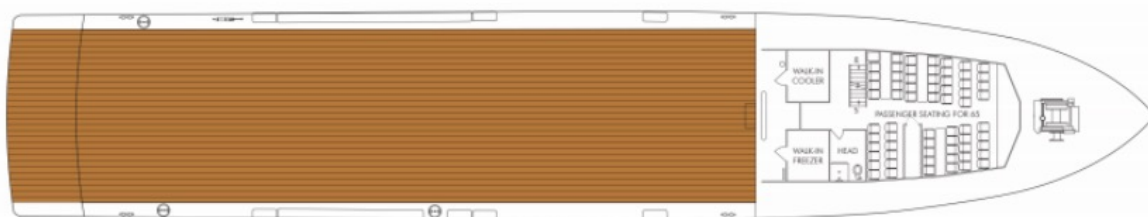

MAIN DECK



ABOVE TANK TOP

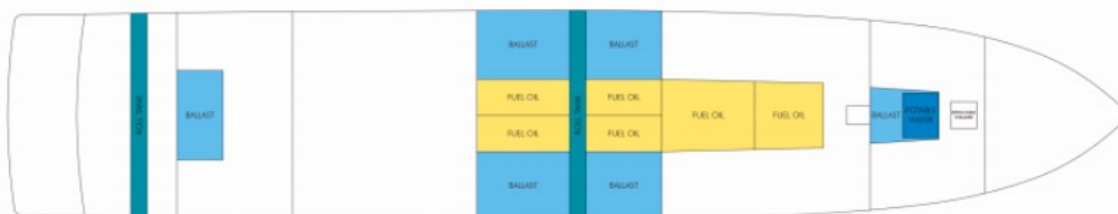

BELOW TANK TOP



PILLOT HOUSE

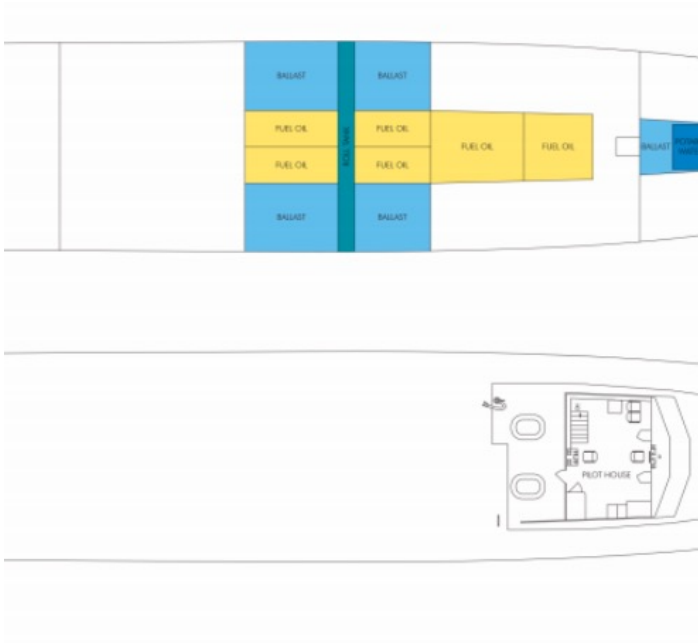
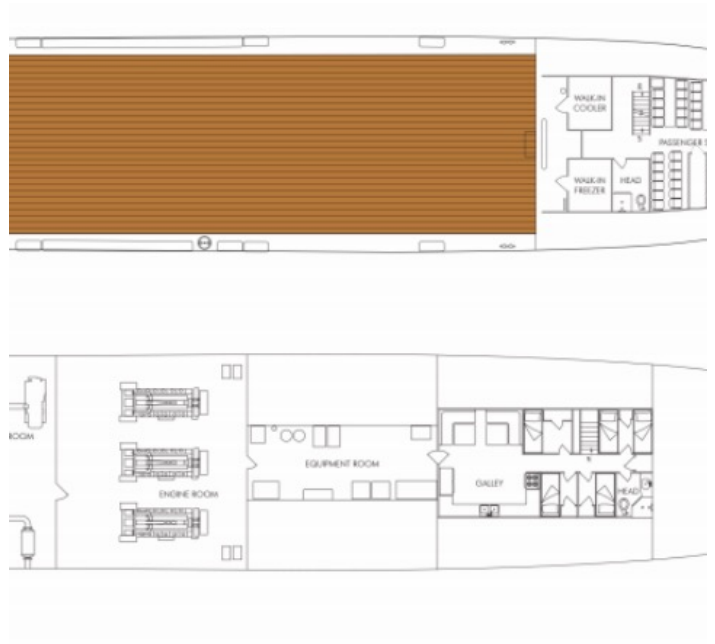
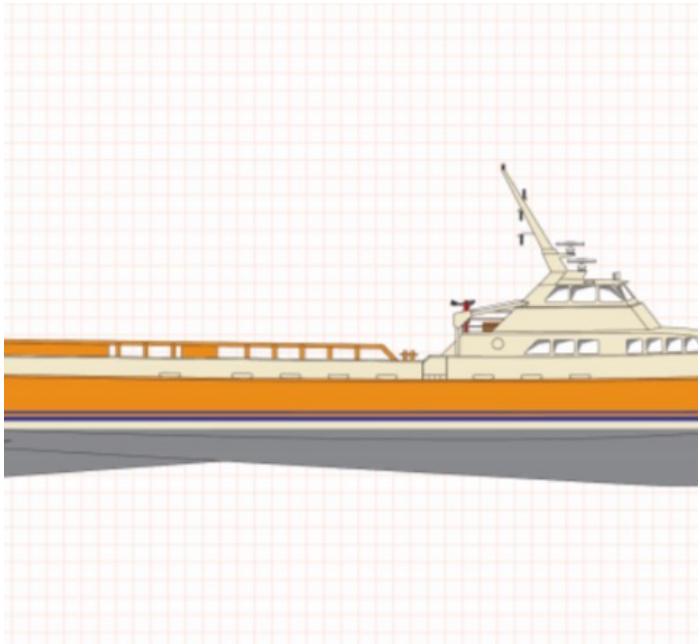

The details of all vessels are offered in good faith but we cannot guarantee or warrant the accuracy of this information nor warrant the condition of the vessel. Any buyer should instruct their agents, or their surveyors, to investigate such details as the buyer desires validated. This vessel is offered subject to sale, price change, location or withdrawal without notice.

