



# SEABOATS

MARINE BROKERS WITH A GLOBAL APPROACH

AUSTRALIA - BULGARIA - INDIA - INDONESIA - ITALY - MALAYSIA - NEW ZEALAND - PANAMA - PHILIPPINES - SINGAPORE - SPAIN - UK - USA - VENEZUELA - VIETNAM

[sales@seaboats.net](mailto:sales@seaboats.net) - [www.seaboats.net](http://www.seaboats.net)

## 21.5m Windfarm Support, Crew Transfer - Survey / Dive Support Vessel



### Listing ID - 1601

**Description** 21.5m Windfarm Support, Crew Transfer - Survey / Dive Support Vessel

**Date** 2013

**Launched**

**Length** 21.5m (70ft 6in)

**Beam** 6.2m (20ft 4in)

**Draft** 1.4m (4ft 7in)

**Location** UK

**Broker** Richard Pierrepont  
[richard.pierrepont@seaboatsbrokers.com](mailto:richard.pierrepont@seaboatsbrokers.com)  
+44 7798 607 323

**Price** Owners are inviting offers

Vessel Type: Aluminium Windfarm Support Vessel

Year of Build: 2013 Refitted 2017

Functions: Crew Transfer, Survey & Diving Support

Class: MCA Cat 2. 12 passengers + 2 Crew, 60 Nm from Safe Haven

Dimensions: LOA: 21.5m, Beam: 6.2m, Draft 1.4m

Speed: Service Speed 22 Knots, Sprint Speed 25 Knots

Engines: 2x 680 HP Caterpillar (86L per hour at service speed per engine)

Propulsion: Shaft driven fixed propeller

Fuel Capacity: 6600 Litres

Range: 750 Nm running at 20 knots

Fresh Water: 450 litres

Water maker: ROM Desalination plant

Aux Power: 13 KVA silenced and keel cooled 220v AC genset

Electrics: DC 12V and 24V electrical systems with 220v AC inverter, shore connection AC system, 220v 50Hz

Survey: Side mounted retractable survey pole

Hydraulics: Hydraulic pump fitted to port engine

Transom: The vessel has an open transom to facilitate loading of large cargo items

Cargo Capacity: 5 Tons

Fuel Transfer: System installed to transfer fuel to a height of 40m

Forward Deck: 5m x 6m, 30m<sup>2</sup>

Crane: 8.5 tons at 1m

Aft Deck: 4,5m x 6m, 27m<sup>2</sup>

Bow Fender: Suitable for access to offshore wind turbines

Accommodation: 4 crew cabins with a total of 6 berths

WC: Heads complete with toilet, shower and sink

### **Deck House:**

Large wheel and deck house seating for 3 crew and 12 passengers on individual suspension seats with headrests, armrests, seatbelts, footrests and storage below. Full galley consisting of oven, microwave, hotplate, fridge and hot water geyser. Saloon type seating and table adjacent to galley area. Blown air heating and radiators throughout.

### **Electronics:**

GPS, 2 fixed VHF radios and one handheld. Magnetic and GPS compass, radar, 2 chart plotters, echo sounder, class A AIS and wind speed indicator. PC running nav package together with internet and office capabilities. Man over board location system.

### **Safety:**

All to code including 2 number 8 man life rafts, 2 side bulwark doors at rescue zones and man overboard davit. CCTV to engine rooms, forward deck and aft deck with recording facility.



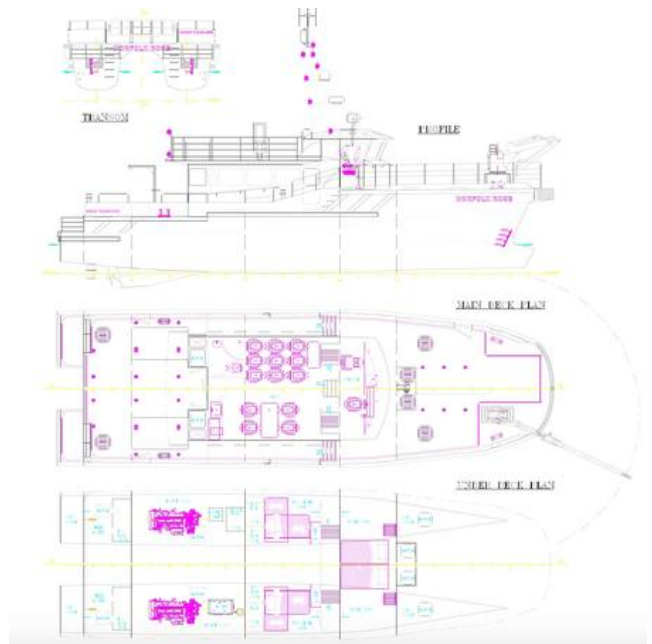



The details of all vessels are offered in good faith but we cannot guarantee or warrant the accuracy of this information nor warrant the condition of the vessel. Any buyer should instruct their agents, or their surveyors, to investigate such details as the buyer desires validated. This vessel is offered subject to sale, price change, location or withdrawal without notice.

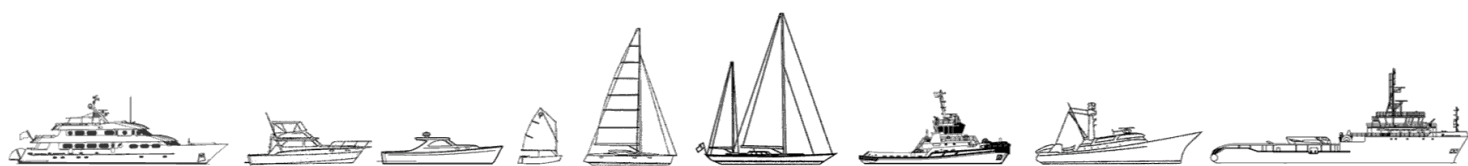

AUSTRALIA - BULGARIA - INDIA - INDONESIA - ITALY - MALAYSIA - NEW ZEALAND - PANAMA - PHILIPPINES - SINGAPORE - SPAIN - UK - USA - VENEZUELA - VIETNAM