



# SEABOATS

MARINE BROKERS WITH A GLOBAL APPROACH

AUSTRALIA - BULGARIA - INDIA - INDONESIA - ITALY - MALAYSIA - NEW ZEALAND - PANAMA - PHILIPPINES - SINGAPORE - SPAIN - UK - USA - VENEZUELA - VIETNAM

[sales@seaboats.net](mailto:sales@seaboats.net) - [www.seaboats.net](http://www.seaboats.net)

## 190ft Offshore Supply Vessel

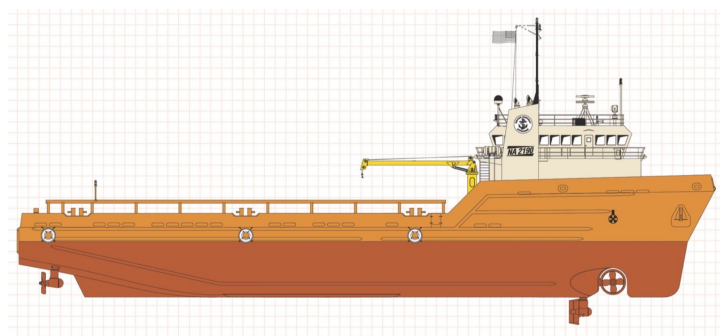

### Listing ID - 2238

**Description** 190ft Offshore Supply Vessel

**Date** 2000

**Launched**

**Length** 57.91m (190ft)

**Beam** 13.41m (44ft)

**Draft** 3.05 m (10 ft)

**Broker** John Kearns  
[john.kearns@seaboatsbrokers.com](mailto:john.kearns@seaboatsbrokers.com)  
+64 21 400 805

### Registration

Hull: 189

Vessel Type: Offshore Supply Vessel

Year Built: 2000

Shipyard: North American Shipbuilding

### Dimensions

Dimensions: 190 ft. X 44 ft. X 19 ft. (57.91 m X 13.41 m X 5.79 m)

Draft (Minimum Operation): 10 ft. (3.05 m)

Draft (Loadline): 16 ft. 3 in. (4.95 m)

Clear Deck: 129 ft. X 35 ft. (39.32 m x 10.67 m)

Cargo Deck Area: 4,515 sq. ft. (419.46 sq. m)

Deck Cargo Capacity: 1,300 LT (1,320.8 MT)

Deadweight Tonnage: 1,915 LT (1,945.73 MT)

### Capacities

Fuel Oil: 121,152 gals. (458.61 cu. m)  
Ballast: 209,144 gals. (791.7 cu. m)  
Potable Water: 14,503 gals. (54.9 cu. m)  
Dry Bulk: 5,880 cu. ft. @ 80 psi (166.5 cu. m @ 5.5 bars)  
Liquid Mud (Dual Tank System): 2,800 barrels (445.16 cu. m)

### **Machinery**

Main Engines: Two (2) CAT 3512 Diesels, 2,560 BHP  
Propulsion: Two (2) Ulstein 900 HD  
Bow Thrusters: One (1) Ulstein TCNS 73/50 Swing Up, 1,200 BHP  
Speed: 13.2 knots  
Generators: Two (2) x 300 kW  
Generators: One (1) x 170 kW Emergency

### **Special Features**

Tuggers: Two (2) x 4 Tons  
Ship Motion: Two (2) Passive Type Anti-Roll Tanks  
Ship Motion: Bilge Keels  
Positioning: DP 1  
Deck Crane: North Pacific Crane Model MCF2045 SWL 4.5 Tons @ 14 m  
Fire fighting: FiFi 1  
Fuel Cargo Pump: Barnes 25 CCE (300 GPM)

### **Life Saving Equipment**

Life Rafts: Four (4) x 20-Man Inflatable Life Rafts  
Rescue Boat/Craft: One (1) x Sea Force 490 SOLAS O/B Rescue Boat  
Other gear as required by authorities

### **Electronics**

Electronics Package: JRC Navtex NCR 300A, Young Wind Tracker, Necode DSC-1000, Sea 330 SSB Radio, Sea watch MF/HF DSC Watch Receiver, Seacall 7000 MF/HG DSC Controller, Seator 3000 Radio Telex Modem, JRC NDH 127C Data Terminal, JRC NQE 3037A Distress Button, JRC JUE-75C Inmarsat-C, Furuno FR1510 Mark 2 Radars, Raytheon HAV398 GPS/Loran, Sea 7156 VHF/FM Radiotelephones, Seacall 7100 VHF DSC Controllers, Furuno FCV-667 Color Video Sounder, EPIRB RLB-27 ACR Electronics, SART RTE-2707 ACR Electronics, Marine Technologies DP 1 System

### **Classification**

ABS: Maltese Cross A1 (Hull)  
ABS: Maltese Cross AMS (Machinery)  
ABS: Loadline  
ABS. DP 1  
AMS U.S. Domestic Service  
USCG: Subchapter L (OSV)

### **Accommodations**

Accommodations: 13



MAIN DECK

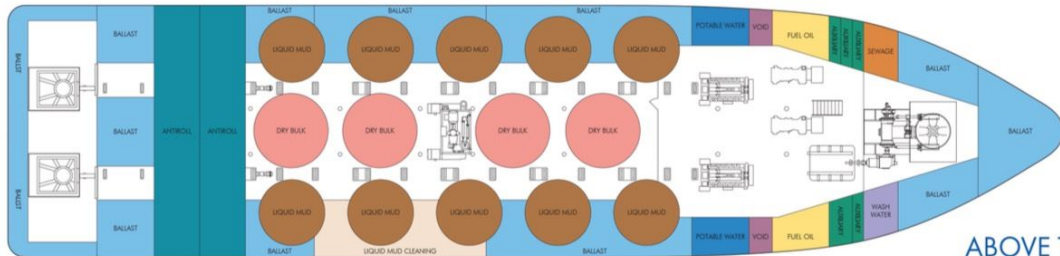

ABOVE TANK TOP



BELOW TANK TOP

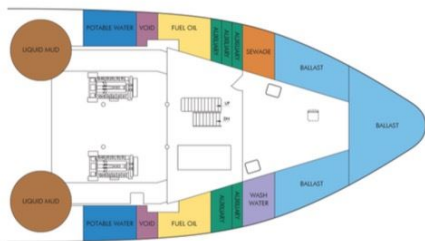

LOWER DECK

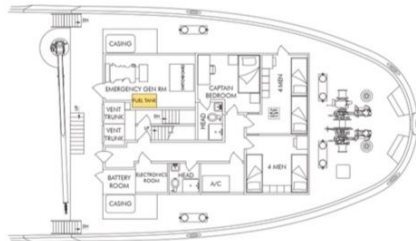

DECK 01

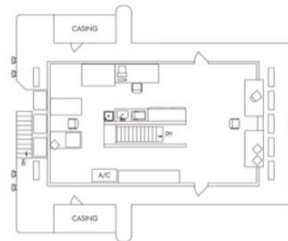

DECK 02



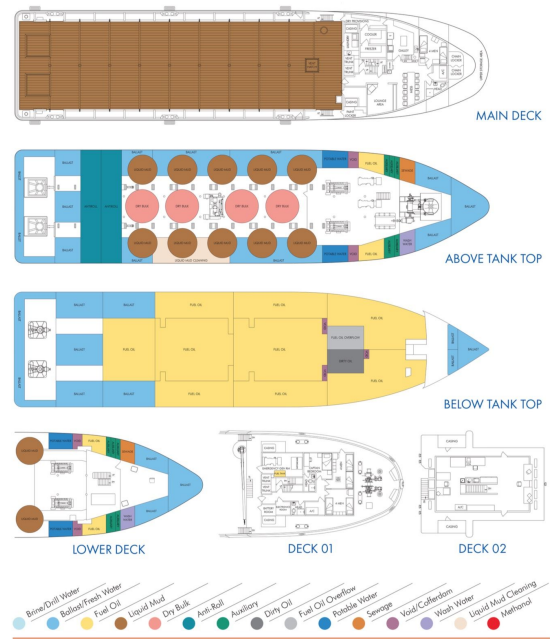
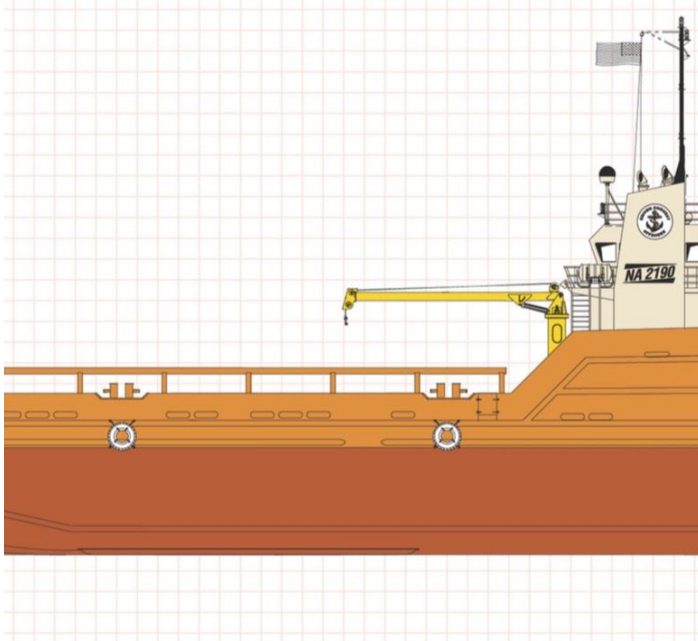

The details of all vessels are offered in good faith but we cannot guarantee or warrant the accuracy of this information nor warrant the condition of the vessel. Any buyer should instruct their agents, or their surveyors, to investigate such details as the buyer desires validated. This vessel is offered subject to sale, price change, location or withdrawal without notice.

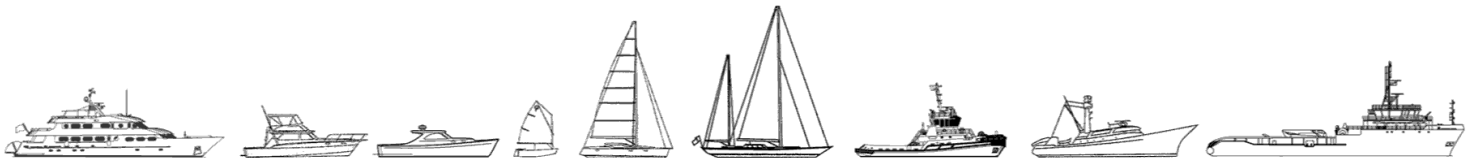

AUSTRALIA - BULGARIA - INDIA - INDONESIA - ITALY - MALAYSIA - NEW ZEALAND - PANAMA - PHILIPPINES - SINGAPORE - SPAIN - UK - USA - VENEZUELA - VIETNAM