



# SEABOATS

MARINE BROKERS WITH A GLOBAL APPROACH

AUSTRALIA - BULGARIA - INDIA - INDONESIA - ITALY - MALAYSIA - NEW ZEALAND - PANAMA - PHILIPPINES - SINGAPORE - SPAIN - UK - USA - VENEZUELA - VIETNAM

[sales@seaboats.net](mailto:sales@seaboats.net) - [www.seaboats.net](http://www.seaboats.net)

## NEW BUILD - 14.98m Catamaran Yacht



### Listing ID - 3619

**Description** NEW BUILD - 14.98m Catamaran Yacht

**Date** Built to Order

**Launched**

**Length** 14.98m (49ft 1in)

**Beam** 8.39m (27ft 5in)

**Draft** 1.05m (3ft 4in)

**Location** ex factory, Bulgaria

**Broker** Georgi Savchev  
[georgi.savchev@seaboatsbrokers.com](mailto:georgi.savchev@seaboatsbrokers.com)  
+359 88 7228674

After 2 years of brainstorming, hardworking and researching the market core values, the ELICA YARD was formed and created 3 types of catamarans, the first of which we are offering here, a 50ft motor catamaran, followed by a luxurious 60ft power and a smaller 40 sailing model.

The OMaya catamarans are made in epoxy resin which guarantees an outstanding lightness, superb strength and longer life! Apart from being extraordinarily light, the most distinctive feature of the OMaya catamarans is their unsinkability. The OMaya is a cosy and at the same time luxurious and practical boat that can move smoothly across all seas.

### Cosy

The boat has a tasteful interior and is cosily decorated with furniture we have produced for you. The OMaya is not only made for luxury. She is also made for the sea and brings you back home safe, wherever your home is.

### Practical and luxurious

It feels like home. It has space like a home. The boat offers sleeping space for 10 people but you can always accommodate 12 people when you convert the seats into beds. All cabins and common spaces are equipped with the latest appliances to ensure you feel comfortable in your private area and give you the sense of your own house but on the other side of the shore.

### **Moving smoothly across all seas**

The OMAYA 50+ is easy to handle by one person.

LOA: 14.98m (49ft 1in)

Length Waterline: 14.27m (49ft 8in)

Beam Overall: 8.39m (27ft 5in)

Draft: 1.05m (3ft 4in)

Unloaded weight 20.5t

Light Displacement (approx.): 45,195 lbs

### **ENGINES**

2 x YANMAR 4LV 150hp

2 x YANMAR 4LV 195hp

2 x YANMAR 4LV 250hp

2 x YANMAR 6LV 400hp

2 x YANMAR 6LV 440hp

Fuel Tank: 2 x 450 L / 630 L / 800L

Fresh Water Capacity: 300 / 400 L

Black / Gray Water Capacity: 3 x 120L

Cabins (up to): 5

Heads (up to): 4

Showers (up to): 4

### **COSY**

The boat has a tasteful interior and is cosily decorated with furniture we have produced for you.

The OMAYA is not only made for luxury. She is also made for the sea and brings you back home safe, wherever your home is.

The OMAYA is a cosy and at the same time luxurious and practical boat that can move smoothly across all seas.

### **PRACTICAL AND LUXURIOUS**

It feels like home. It has space like a home.

The boat offers sleeping space for 10 people but you can always accommodate 12 people when you convert the seats into beds.

All cabins and common spaces are equipped with the latest appliances to ensure you feel comfortable in your private area and give you the sense of your own house but on the other side of the shore.

1. The OMAYA P is the version with one large master cabin on the port side and two cabins on the starboard side as per the render below;

## OMAYA 50 LAYOUT

### 3 CABIN HULLS

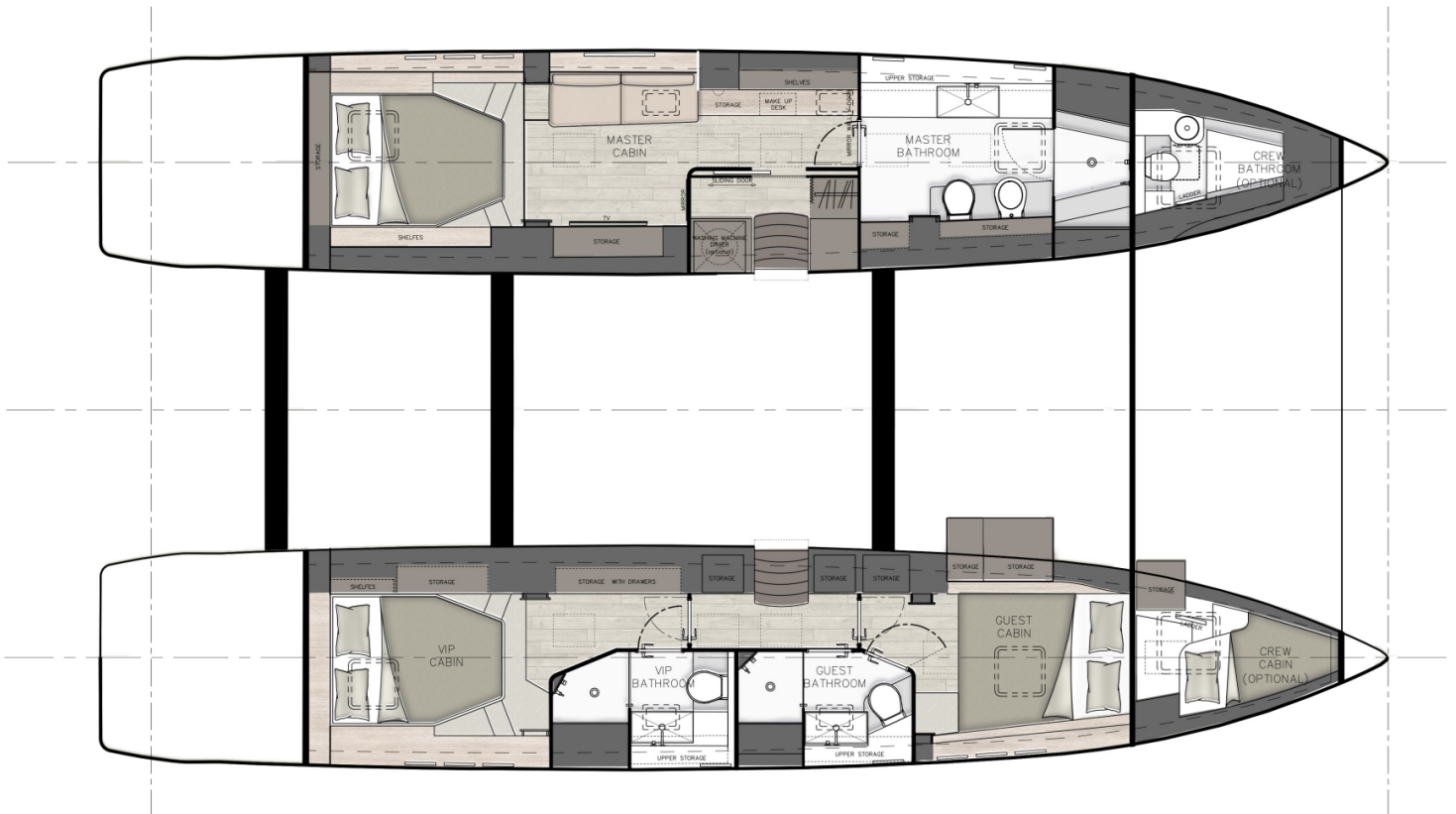

2. The Omayya C is the charter version with 4 double cabins and space for up to two crew cabins as per the render below;

## OMAYA 50 LAYOUT

### 4 CABIN HULLS

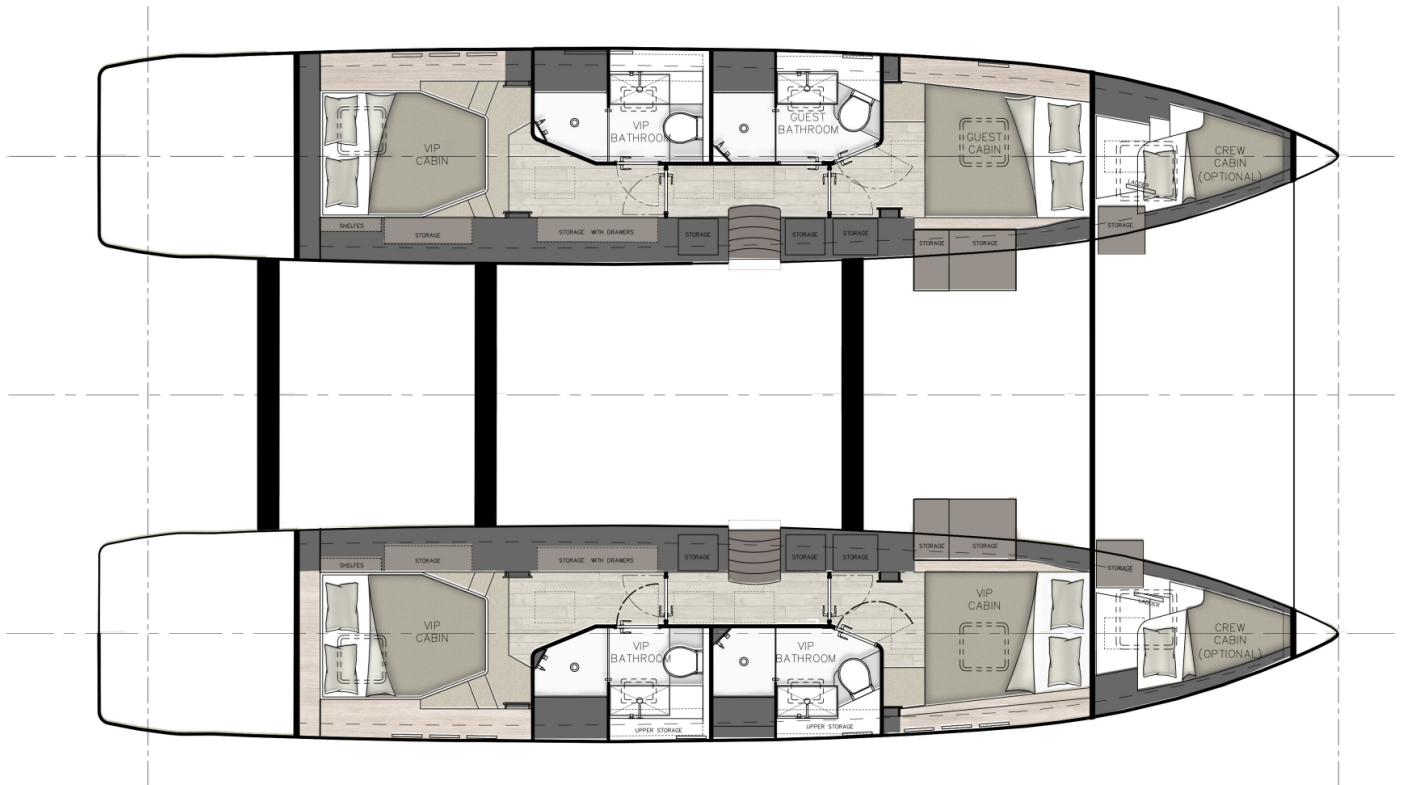

The only difference in the two versions is the lower deck layout.

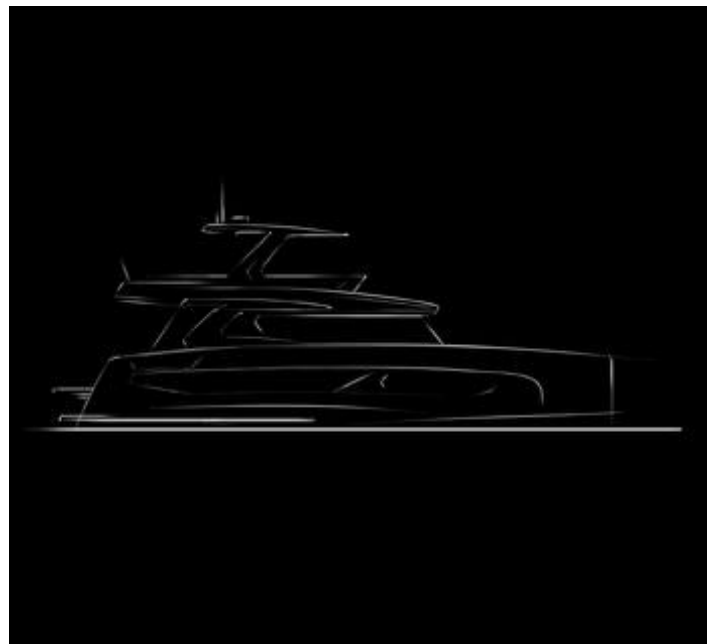





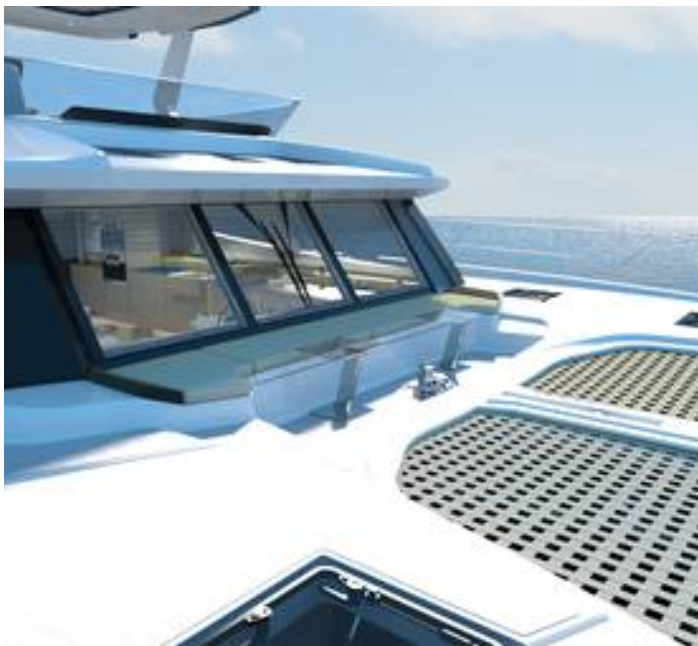













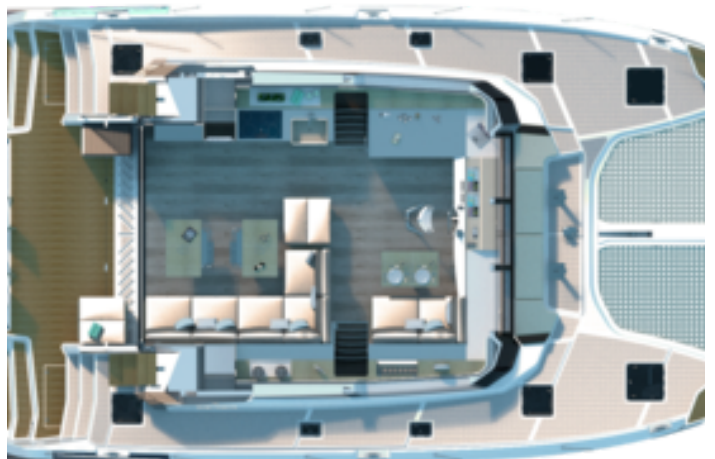

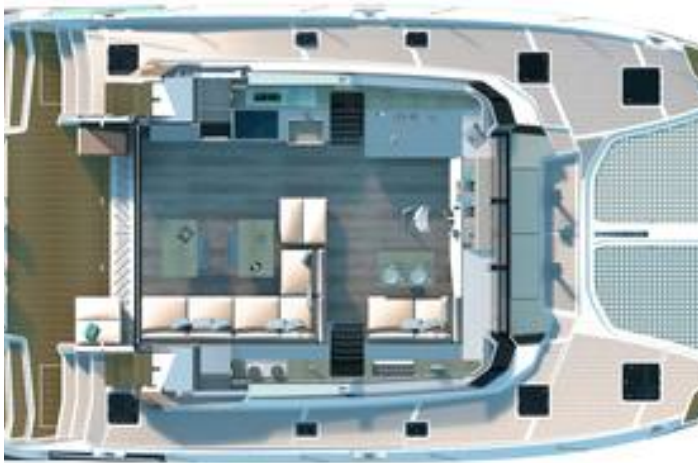

OMAYA 50 LAYOUT  
3 CABIN HULLS

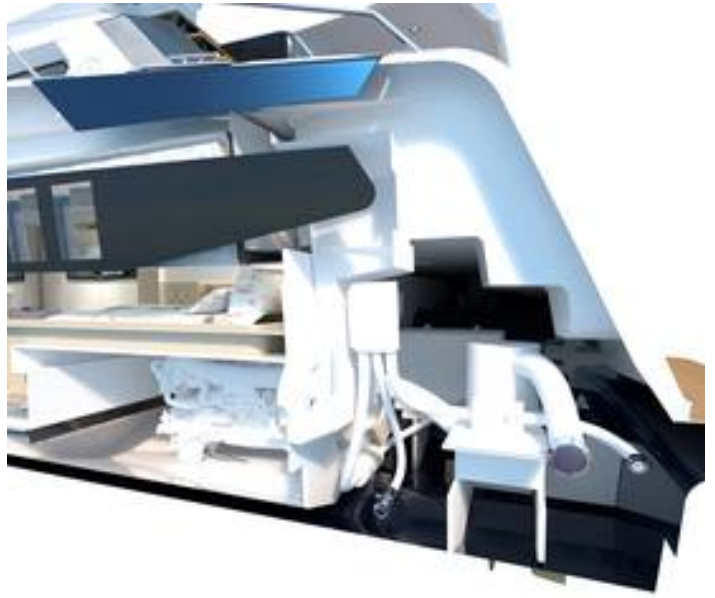

OMAYA 50 LAYOUT  
4 CABIN HULLS

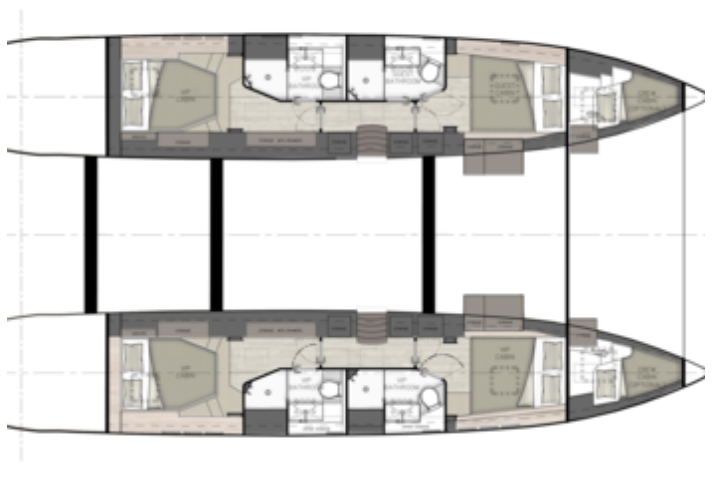

The details of all vessels are offered in good faith but we cannot guarantee or warrant the accuracy of this information nor warrant the condition of the vessel. Any buyer should instruct their agents, or their surveyors, to investigate such details as the buyer desires validated. This vessel is offered subject to sale, price change, location or withdrawal without notice.

