



# SEABOATS

MARINE BROKERS WITH A GLOBAL APPROACH

AUSTRALIA - BULGARIA - INDIA - INDONESIA - ITALY - MALAYSIA - NEW ZEALAND - PANAMA - PHILIPPINES - SINGAPORE - SPAIN - UK - USA - VENEZUELA - VIETNAM

[sales@seaboats.net](mailto:sales@seaboats.net) - [www.seaboats.net](http://www.seaboats.net)

## 2008 50m 4400 BHP AHT



### Listing ID - 3705

**Description** 50m 4400 BHP AHT

**Date** 2008

**Launched**

**Length** 50m (164ft)

**Beam** 12.60m (41ft 4in)

**Draft** 4.80m (15ft 8in)

**Location** Malaysia

**Broker** Hanni Ajik

**Price** POA

**Price Notes** As is where is. Vessel is available for inspection by appointment. Negotiable for serious buyer.

### Dimensions

LOA: 49.95m

Breadth Moulded: 12.60m

Depth Moulded: 5.75m

Draft: 4.80m

Deadweight: 700 T

Registered Tonnage: GRT 959 T, NRF 287 T

## Registration

Year / Built / Builder: 2008 / Shin Yang Shipyard SDN BHD

Flag / Port of Registry: Malaysia / Kuching

Class: BV

## Capacities

Fuel Oil: 500m<sup>3</sup>

Fresh Water: 242m<sup>3</sup>

Water Ballast / Drill Water: 65m<sup>3</sup>

Dispersant / Foam: 19m<sup>3</sup> / 16m<sup>3</sup>

Freezer and Cooler: 5m<sup>3</sup> / 5m<sup>3</sup>

Clear Deck Area: 220m<sup>3</sup>

Deck Strength: 5T

## Navigation and Communication

Inmarsat C: 2 x Furuno Felcom 15

GMDSS: Comply GMDSS A1+A2+A3

Radars: 1 x Furuno FE-700, 1 x Furuno FR-1510 Mark II

GPS Navigator: Furuno GP-150

Autopilot: Simrad AP-50

Navtex Receiver: Furuno NX-700

Gyro Compass: Tokyo Kelki TG-8000

Magnetic Compass: Daiko SR-150 PK

Communications: Data / Fax / Phone: FBB Sailor 150

MF / HF SSB DSC: Furuno 2571C

Echo Sounder: JMC F2000

VHR Radio Telephone: 2 x Furuno FM-8800

GMDSS Hand Held Radio: 3 x ICOM ICGM-1600

SART: 2 x Sevenstar S701

EPIRB: GME MT 403 FF

Wind Indicator: Clipper

Barometer: Hanseatic

AIS: Furuno FA-150

BNWAS: SME Electius le guardian 2025

ECDIS: Trasan NS400

SVDR: Headway SVDR

SSAS: Furuno Felcom 15

## Machinery

Main Engines: 2 x Cummins QSK 60 (2 x 2200 BHP)

Propulsion: Manganese Bronze / 4 Blade solid fixed pitches in Kort Nozzle

Bow Thrusters: 3.5 T / 350 HP (Cummins Engine)

Main Generator: 2 x Cummins QSM11-D(M) 2 x 265 kW

Emergency Generator: 1 x Cummin 6CT8.3-D (M) 150 kW

Oily Water Separator: Georim Engineering, GRS-10EB, 1m<sup>3</sup>/hr

Sewage Treatment Plant: ISS-35 (2.1m<sup>3</sup> /day)

## Towing / Anchor Handling / Mooring

Towing Drum Wire: 52mm x 1000m

Stern Roller: 120 T

Karm Fork / Towing Pin: 200 T / 200 T  
Towing Winch: 80 T Double Drum  
Anchor Windlass: 6.2 T x 10m / min  
Anchors: 2 x Stockless Bower Anchor 1300kg  
Anchor Chain: 38mm Dia. X 27.5m x 20 length each side  
Capstan: 2 x 5T @ 15m/min

### **Performance**

Max Speed: 12 knots  
Service Speed: 10 knots  
Bollard Pull: 54.8 T

### **Transfer Rates**

Fuel Oil: 70m<sup>3</sup> /hr @ 50m head  
Fresh Water: 70m<sup>3</sup>/hr @ 50m head

### **Fire-fighting and Anti-pollution Equipment**

FIFI System: FiFi-1  
FIFI Monitors: 1200m<sup>3</sup>/ hr (Water), 300 /hr (Foam)-Joystick controlled  
FIFI Pumps: 1200 m<sup>3</sup> /hr @ 120m head  
CO2 System: 16 x 45 kg CO2  
Fire Hydrants: 12 nos.  
Fire Extinguishers: 2 x 45 L foam, 5 x 9 L water, 6 x 9 L foam, 1 x 9 kg, 14 x 6 kg DP  
Fast Rescue: Rigid Rescue Boat, 6 Persons, SC45KR, 30 HP Petrol Engine  
Safety Equipment: 4 BA Set, 13 EEBD, 2 x 20 and 2 x 25 per life raft  
H2S: Crowcon, 4 Sensors

### **Accommodation**

27 Men  
1 Man x 3  
2 Men x 6  
4 Men x 3



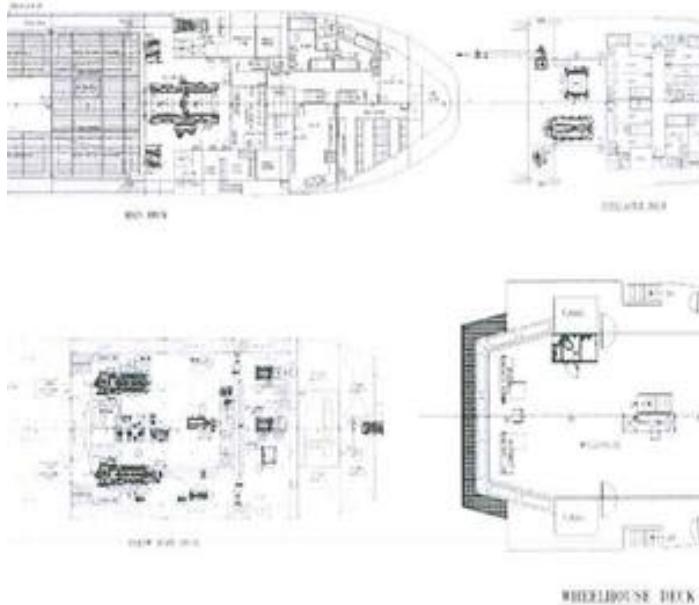
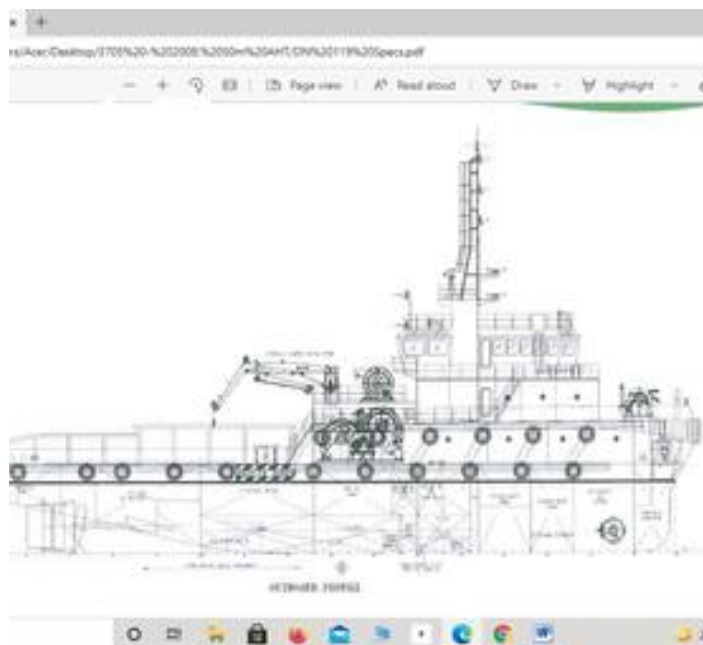

The details of all vessels are offered in good faith but we cannot guarantee or warrant the accuracy of this information nor warrant the condition of the vessel. Any buyer should instruct their agents, or their surveyors, to investigate such details as the buyer desires validated. This vessel is offered subject to sale, price change, location or withdrawal without notice.

