



# SEABOATS

MARINE BROKERS WITH A GLOBAL APPROACH

AUSTRALIA - BULGARIA - INDIA - INDONESIA - ITALY - MALAYSIA - NEW ZEALAND - PANAMA - PHILIPPINES - SINGAPORE - SPAIN - UK - USA - VENEZUELA - VIETNAM

[sales@seaboats.net](mailto:sales@seaboats.net) - [www.seaboats.net](http://www.seaboats.net)

## NEW BUILD - 26m ERV

*26m Emergency Response Vessel*



### Listing ID - 411105

**Description** 26m Emergency Response Vessel (ERV)

**Date Launched** 12 months from contract signing

**Length** 26.4m

**Beam** 9m

**Draft** 1.87m

**Location** ex Factory, China

**Broker** Geoff Fraser  
[geoff.fraser@seaboats.net](mailto:geoff.fraser@seaboats.net)  
+64 21 61 222 5

**Price** approx USD 4m depending on spec

The KINGTOUGH 26M Emergency Response Vessel is designed on a basis of proven hull that has been under satisfactory operations for years. Designed by Mark Williamson Design of Australia, also acting as technical backbone of world-renowned shipyard Austal for fast offshore crew boat, patrol boat and ferry.

This high speed crew boat is designed for multi-mission/purposes such as Crew transport, Cargo transport, Disaster Relief operations and Surveillance.

Hull & superstructure are 5083# aluminium

Main Engines are ( 2 x CAT C18, 651KW @ 2200rpm

Gearbox: 2 x ZF 665 2 x HJ 403

Auxilliarities: 2 x Cummins 4BT 3.9D(M) 62kVa

Fuel Tanks: 2 x 4000 L

Water Tanks: 2 x 1500 L  
Max Speed: 27.5 knots  
Accom: 8-20  
Range: ( 449 nautical miles

This Vessel is designed as a High Speed Aluminium Catamaran for coastal service, featured with “semi-swath” hull form incorporating bulbous bows.

#### Survey and Classification

The vessel shall be classed Det Norske Veritas (DNV) with the notation 1A1 HSLC R3 Patol, and shall comply with the requirements of China Classification Survey or any other Survey that are specified by buyer.

#### Navigation and Communication Equipment include:

Furuno Model 1510 15” Radar with 6 ft antenna 15mtr cable ARP17 Plotter GCY8 Gviro converter JMC 1400 Dual frequency sounder 50/200 1kw( JMC NP-30NT with GPS ANTENNA( ICOM-M700 complete with tuner and Banten HF antenna

ICOM IC-M502 VHF Radio with Banten antenna Sailor C2906 Inmarsat M Navicontrol Autopilot 3003 Gold with second station Cetrek “Poseidon” compass

Den Gaan DHR CS-220 Searchlight( Closed circuit TV monitoring of engine room and main deck. All navigation equipment interfaced to Bridge displays.



GA--Bird's View.jpg



GA--Longitudinal Tunnel Girder.jpg



16m Emergency Response Ves.



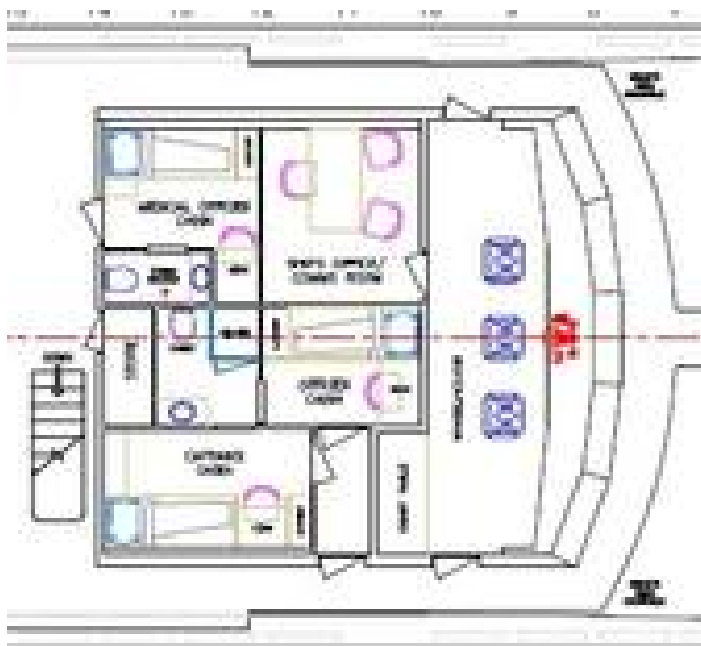
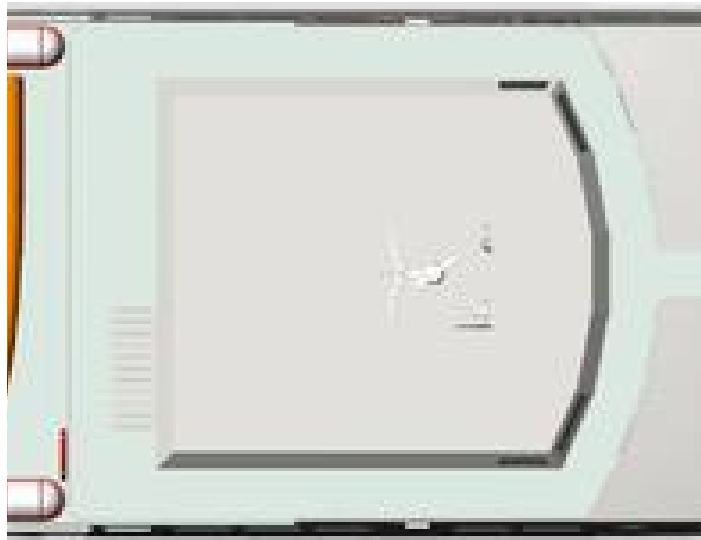

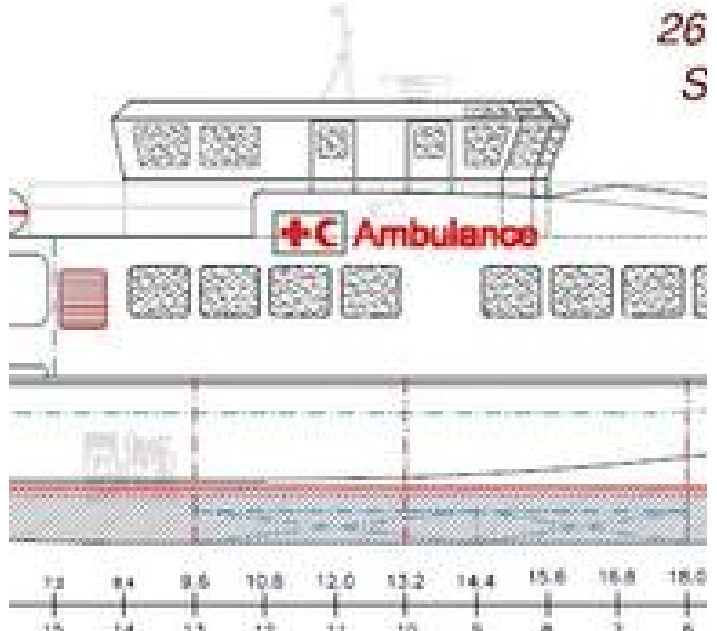
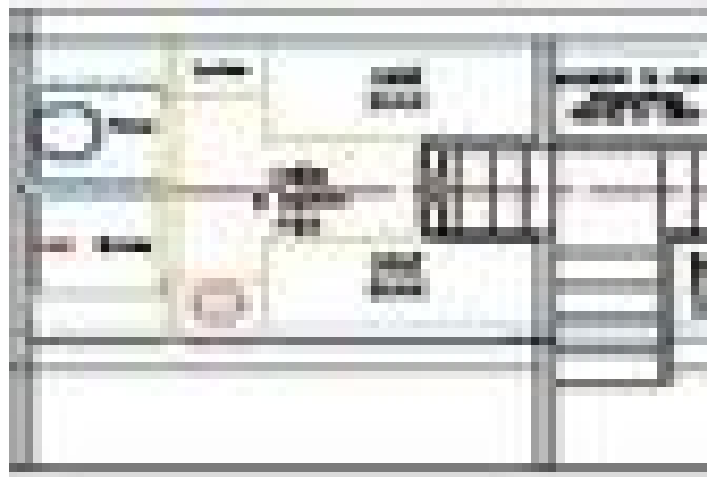
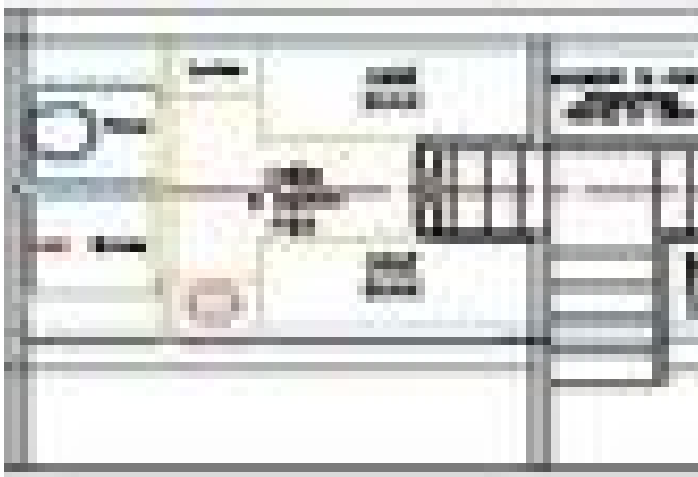

The details of all vessels are offered in good faith but we cannot guarantee or warrant the accuracy of this information nor warrant the condition of the vessel. Any buyer should instruct their agents, or their surveyors, to investigate such details as the buyer desires validated. This vessel is offered subject to sale, price change, location or withdrawal without notice.

