



SEABOATS

MARINE BROKERS WITH A GLOBAL APPROACH

AUSTRALIA - BULGARIA - INDIA - INDONESIA - ITALY - MALAYSIA - NEW ZEALAND - PANAMA - PHILIPPINES - SINGAPORE - SPAIN - UK - USA - VENEZUELA - VIETNAM

sales@seaboats.net - www.seaboats.net

NEW BUILD - Tomahawk 96 Superyacht



Listing ID - 4227

Description	Tomahawk 96 Superyacht
Date Launched	Built to Order
Length	96m (314ft 11in)
Location	Italy
Broker	Giuseppe Filippone giuseppe.filippone@seaboatsbrokers.com +39 329 886 8343
Price	POA

The Tomahawk 96 takes shape from the natural evolution of the studies on Ax-bow type hulls within Dynaship Yacht Design, carried out with the aim of developing a complete line of pleasure boats, based on the explorer concept.

Inspired by the Ax-Bow, and containing within it the basic principles of an explorer, the project is focused on the concept of seakeeping, a feature significantly improved thanks to the particular design of the bow, which allows to drastically limit the level of vertical accelerations, improving notably the comfort of navigation.

The Tomahawk 96 was developed around the concept of conviviality and this has influenced several choices, including aesthetic ones.

As far as the layout is concerned, we have opted to bring the more convivial areas aft where a large double staircase on two levels leads us to the main-deck with the main swimming pool / sundeck area. The garage with the sea toys is located below this area. From the Main Saloon of the Main-Deck, a large spiral staircase leads to the second saloon with terraces. From here to the bow the more private areas of the ship follow one another with the VIP area and guests.

On the upper deck we find, aft, another convivial area with the outdoor dining area, and further forward, separated by the vertical distribution column that crosses all decks, the owner's suite. The helicopter area is even further

forward, with the expandable landing strip and the space for sheltering the helicopter itself. On the upper decks we find the command bridge and the fly, another important convivial area.

Starting from the assumption that there was the need to create an explorer, which by its very nature implies a long-range navigation in which, in adverse weather and sea conditions, it is not possible to find shelter, but must be addressed, the hull Ax-Bow seemed the ideal solution. The project is therefore necessarily focused on the concept of seakeeping, features significantly improved thanks to the particular design of the bow, which drastically limits the level of vertical accelerations, significantly improving navigation comfort.

Another fundamental effect induced by the use of this type of hull is the increase in the waterline, which, in conjunction with the fineness of the water lines, generates less resistance at high speeds with a relative significant reduction in consumption.

As far as cruising speed is concerned, you can think of high speeds with safer navigation and negligible consumption. As far as consumption is concerned, an electric diesel propulsion is envisaged which, by exploiting the very high torques of the electric motors, makes consumption much more leveled. All this with a zero-emission autonomy of about 240 minutes at 10 knt to be used to enter protected areas off-limits to hydrocarbon navigation.





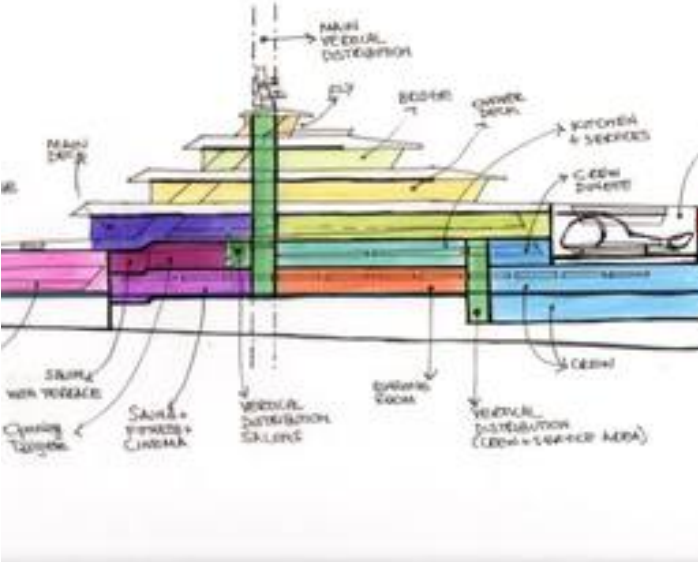

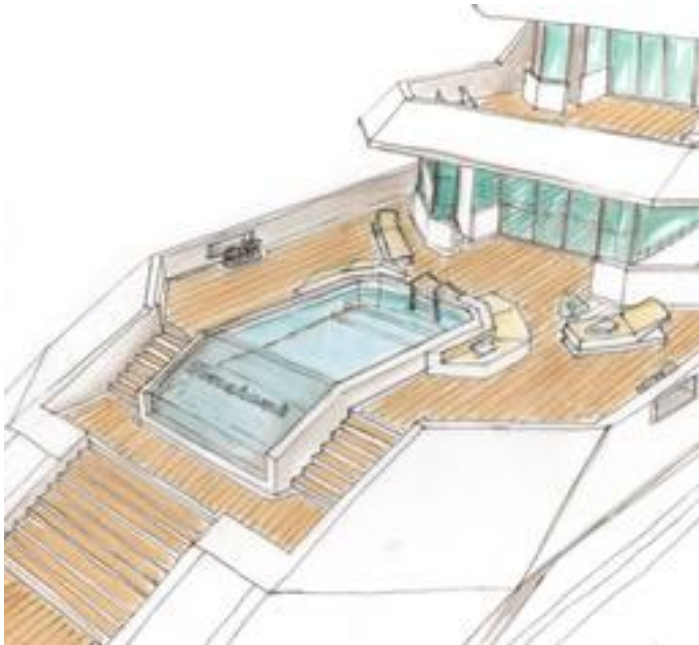
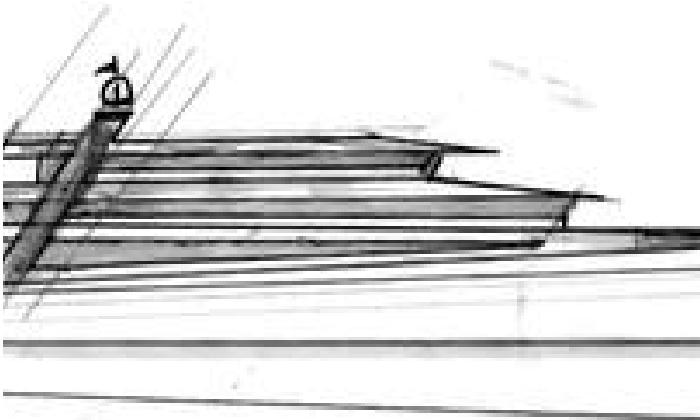

The details of all vessels are offered in good faith but we cannot guarantee or warrant the accuracy of this information nor warrant the condition of the vessel. Any buyer should instruct their agents, or their surveyors, to investigate such details as the buyer desires validated. This vessel is offered subject to sale, price change, location or withdrawal without notice.



AUSTRALIA - BULGARIA - INDIA - INDONESIA - ITALY - MALAYSIA - NEW ZEALAND - PANAMA - PHILIPPINES - SINGAPORE - SPAIN - UK - USA - VENEZUELA - VIETNAM