



# SEABOATS

MARINE BROKERS WITH A GLOBAL APPROACH

AUSTRALIA - BULGARIA - INDIA - INDONESIA - ITALY - MALAYSIA - NEW ZEALAND - PANAMA - PHILIPPINES - SINGAPORE - SPAIN - UK - USA - VENEZUELA - VIETNAM

[sales@seaboats.net](mailto:sales@seaboats.net) - [www.seaboats.net](http://www.seaboats.net)

## 75ft Classic Bermudan Ketch



### Listing ID - 4391

**Description** Philip Rhodes 75 ft Bermudan Ketch

**Date** 1958 /2013

**Launched**

**Length** 22.96m (75ft 4in)

**Beam** 5.64m (18ft 6in)

**Draft** Board Up 9ft 0in/2.74m -- Board Down 14ft 6in / 4.42m

**Location** Auckland NZ

**Broker** Clive Bennett  
[clive.bennett@seaboatsbrokers.com](mailto:clive.bennett@seaboatsbrokers.com)  
+64 27 494 9799

**Price** €600,000

### Overview:

KAMALII is a magnificent yacht and represents the ultimate conclusion of traditional timber boat construction. The current owners have sailed around the world on many yachts, and the yacht is without doubt the most comfortable, sea kindly, sturdy ocean-going vessel they have ever sailed. With only a handful of owners in her life she has been the love and passion of all who have owned her. Featuring a deep, full keel hull form for enhanced windward performance for this deceptively fast and exceptionally comfortable cruiser. The present owners purchased the vessel in California and after major hull restoration, in 2013 cruised the Pacific to her new life in New Zealand where upgrading has continued in between use as a family cruiser with the finest of pedigrees. A detailed history is available on request.

### Specification:

### Restoration / Refits

## 2013 - present Auckland

- Extensive work on the interior and exterior
- New electronics
- Upgrading electrical system
- New batteries
- Further work on the spars, including:
  - Pulling the main mast in 2020 to undertake refurbishment work
  - Further replacement of the standing rigging.
- Interior and exterior repainting and re-varnishing
- New cockpit cushions
- New main and mizzen sail covers

## - 2012 - Newport USA

- Much underbody inner and outer plank replacement
- Underbody refastening
- Much standing rigging replaced
- Systems fully serviced and overhauled where necessary

## **Construction**

- Double-planked mahogany on laminated white oak frame
- Oregon pine selves and clamps
- White oak and spruce deck beams
- Deck-to-keel bronze strapping
- Bronze fastenings
- Bronze floors
- Bronze mast steps
- Bronze centre-board
- Solid 1 3/4 in/ 45 mm teak deck
- Teak superstructure
- 2 x Evadur solid bronze water-tight bulkheads

## **Deck Layout, equipment and ground tackle**

U-shaped raised helm area with seating for eight has a stainless and plexiglass spray dodger forward. There are two removable forward hatches (racing “doghouse” and conventional). The upper saloon has custom roll-up opening side windows. Combined with the classic Rhodes large deck saloon, they make for an extremely comfortable, light and airy space, leaving the decks free for sail handling and leisure.

- Stainless boom gallows
- Stainless steel bow and stern pulpits
- Stanchions with double life lines
- 2 x Deck Stowage boxes
- Numerous winch handles

## **Sheet Winches**

- 2 x Sheet winches main sheet.
- 4 x Sheet winches foredeck
- 4 x Barient self tailing sheet winches aft deck
- 2 x Mizzen mast sheet winches

## **Ground Tackle**

- 230 V AC Electric Ideal Windlass
- 2 x Horizontal chain gypsies; 1 x vertical warping drum
- Bronze anchor davit system
- 1 x 105 lb CQR anchor
- 2 x 65 lb Danforth anchors
- 330 ft ½" High test chain
- Salt water deckwash pump

### **Deckhouse Saloon**

- Dual navigation stations with very large navigation table
- Extensive chart storage under and in overhead lockers
- Dining table and seating to port
- Settee to starboard with pilot chair
- Full standing height engine room directly underneath
- Incredibly spacious, making for easy service and maintenance of systems
- 1 x Washing Machine, Samsung 7.5 kg

### **Galley**

- 2 x Gimbale tables (bronze)
- 1 x Microwave
- 1 x Electric fan oven
- 1 x Gas hob (4 burner).
- 1 x Cold plate refrigerator system
- 1 x Cold plate freezer system
- 1 x Drinks cooler refrigerator

### **Accommodation**

Three good sized aft cabins providing the main accommodation, with a V-berth in the fore-peak for crew, or as a guest double. Plus stowage locker

Guest double Cabin

Guest Twin Cabin

Guest - Toilet and shower

Master Cabin and ensuite

- Double berth to starboard
- Single berth to port
- Hanging lockers
- Overhead deck hatch

**Lazarette** - accessed through hatches in the aft cabin deck

### **General**

- 2 x Vacu-Flush 24 V marine toilets
- with 100 Gallon plastic holding tank and pump out
- 2 x 220 V AC ½ HP compressor for refrigeration/ freezer
- 1 x Hot water tank with engine heat-exchanger and 230V electric heating
- Pressurised water system with triple redundant water pumps and accumulator tank
- Dock-side water hookup direct into house system with pressure regulator
- 2 x Water makers (currently decommissioned)

### **Rig, Sails and Canvas work**

Bermudan ketch Rig

Hollow sitka spruce main mast

- Merriman winch tensioned topmast backstays
  - Merriman Highfield lever-tensioned running backstays
  - 2 x Barient halyard winches (wire reel)
  - 1 x Merriman halyard winches (wire reel)
  - 1 x Rope reefing winch
  - Spruce main boom
  - 1 x Main boom topping lift
- Sitka spruce mizzen mast

- 1 x Barient halyard winch (wire reel)
- 1 x Merriman halyard winch (wire reel)
- 1 x Barient rope reefing winch
- Merriman Highfield lever tensioned running backstays
- Spruce mizzen booms
- Spreader lights

### **Sails**

- 2x Main sails (one working; one free-footed “delivery” sail)
- 2 x Mizzens
- 1 x Furling Genoa
- 1 x Furling jib
- 2 x Staysails (one free foot, one for self-tacker)
- 1 x Mizzen staysail
- 1 x Storm trysail
- Vessel was fitted with a self-tacking staysail
- Current owners have removed
- All components are in storage and come with the vessel

### **Covers**

- Mainsail cover
- Mizzen sail cover
- Full boat sunshade/ weather cover with wooden poles
- Various canvas covers.

### **Mechanical**

- Cummins V-8 300-M 300 hp diesel
- ZF dual clutch electric transmission
- 2 ¼ in / 57 mm Monel shaft
- 4 x Fixed blade bronze 30 RH 20 aperture mounted propeller
- Electrical Generators:
- 1 x Northern Lights PX-G 302 12KW (902.5 hrs)
- 1 x Northern Lights PX-G 302 12KW (870.5 hrs)

### **Electrical**

- 12V, 24V DC, and 120/240 V AC
- System presently configured for 230 AC house outlets
- Can be readily converted back to 115 V AC
- LED lighting throughout.

House batteries:

- 4 x 220 Ah 6V lead-acid in series for 24V
- 12 V DC for electronics, sound system, etc supplied via 2 x DC-DC converters

Engine batteries:

- 2 x N200 1000CCA 12V in series

Chargers:

- House Alternator: 150A 24 V; 7-step multi-stage smart regulator
- Engine Alternator: 1 x 80A 24VDC Motorola
- 1 x 40 Amp 24V multi-bank battery charger
- 1 x 25 Amp 12V multi-bank charger
- Switchable shore-power connection with galvanic isolator.

## **Tankage**

Fuel:

- 875 Gal / 3312 L in 5 x Monel tanks
- 120 Gal / 454 L in 1 x Converted water tank
- Fuel transfer pump

Water:

- 500 Gal / 1893 L in 2 x Monel tanks
- 2 x Water makers
- BEP Marine electronic tank level and power/ Ah meter.

## **Navigation, Communications and Electronics**

### **Navigation**

- Cockpit Compass: 7 in /17 cm Kelvin and Wilfred liquid
- PC-based navigation computer with dual screens
- Integrated to NMEA data bus
- B&G Triton display
- AC42N autopilot with electric drive
- B&G wind
- Garmin NMEA2000 GPS
- B&G NMEA compass
- Rudder angle indicator

### **Communications**

- ICOM SSB Radio (ICOM) with independent ground plane and auto tuner
- Standard Horizon VHF Radio 25 W with AIS receiver and remote cockpit mic
- On-board Wi-Fi and mobile internet

### **Entertainment**

- Lower salon has an entertainment computer (Netflix etc)
- Connected to ships network and data storage
- 1200 watt four channel stereo plus subwoofer, connected to ship computer

### **Safety**

- 6 x Removable storm windows for upper saloon
- 1 x 6-Person life raft (2013 - currently out of test)
- 406 Mhz EPIRB
- 2 x Emergency axes
- 1 x MOB inflatable retrieval unit; 1 x Lifesling, 2 x liferings.
- 3 x 24 V DC 3700 Gal p/h Rule primary bilge pumps

- Engine-driven high volume emergency bilge pump
- Switchable manifold between bilge compartments
- Additional manual bilge pump for aft bilge (fitted but not plumbed)

#### **Alarm systems:**

- Bilge high water alarm (per compartment)
- Connected to GSM module for alarm SMS messaging
- Engine oil pressure
- Engine high temperature.
- 4 x Fire extinguishers
- Emergency steering, stowed in lazarette.

#### **Other Equipment**

Tender - 3.5 aluminium RIB (Aquapro SMR 1101)

- 5 hp Tohatsu outboard motor
- Stern ensign flagpole
- Huge inventory of Merriman traditional bronze blocks and snatch-blocks
- Extensive spares and parts, including:
  - Numerous winches
  - Bronze seacocks
  - Electrical and plumbing parts, etc
- New Blue Water bronze lip-seal shaft seal assembly
- Not fitted yet but intended to replace shaft stuffing box
- Assorted brightwork and winch covers, lines, etc
- Original signalling flag kit
- Swim ladder
- 6 x Boat fenders
- Teak side dock ladder with platform
- 1 x Portable Stainless BBQ

























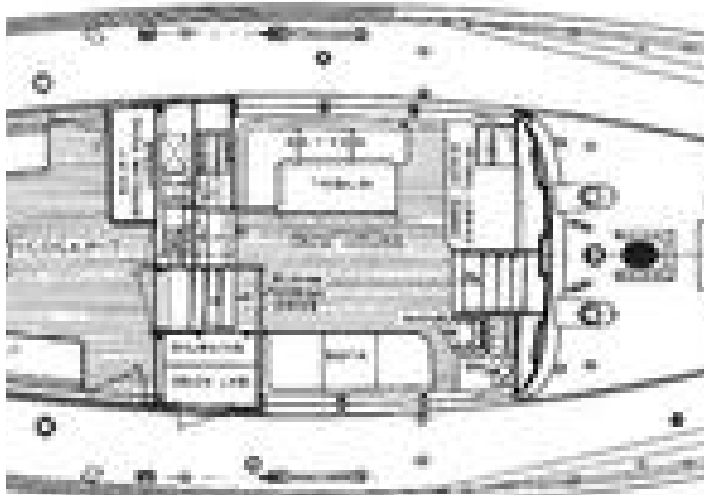
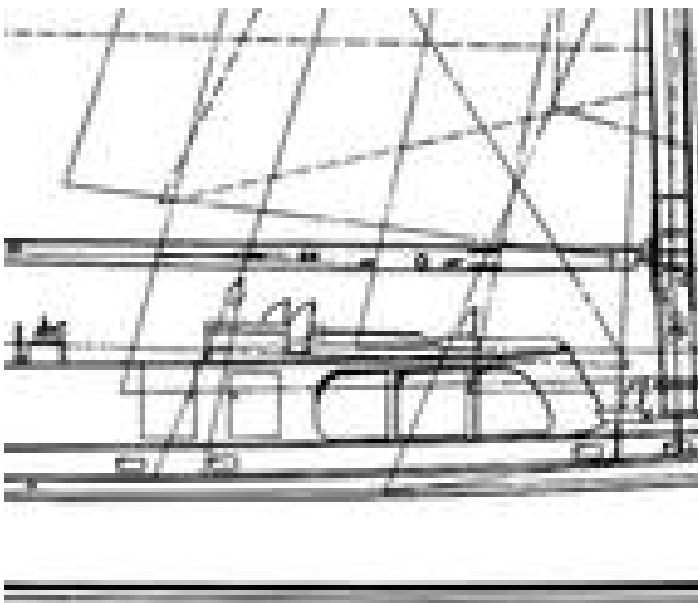
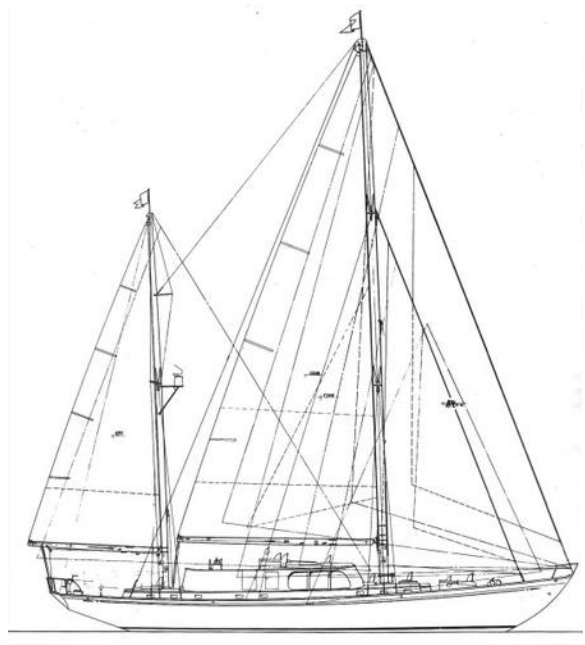

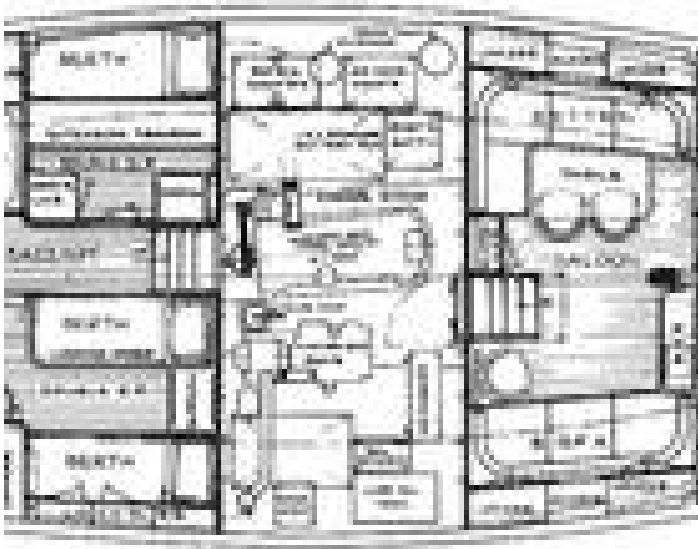

The details of all vessels are offered in good faith but we cannot guarantee or warrant the accuracy of this information nor warrant the condition of the vessel. Any buyer should instruct their agents, or their surveyors, to investigate such details as the buyer desires validated. This vessel is offered subject to sale, price change, location or withdrawal without notice.

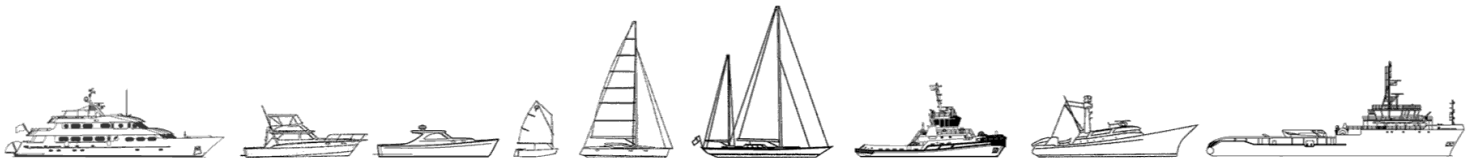

AUSTRALIA - BULGARIA - INDIA - INDONESIA - ITALY - MALAYSIA - NEW ZEALAND - PANAMA - PHILIPPINES - SINGAPORE - SPAIN - UK - USA - VENEZUELA - VIETNAM