



SEABOATS

MARINE BROKERS WITH A GLOBAL APPROACH

AUSTRALIA - BULGARIA - INDIA - INDONESIA - ITALY - MALAYSIA - NEW ZEALAND - PANAMA - PHILIPPINES - SINGAPORE - SPAIN - UK - USA - VENEZUELA - VIETNAM

sales@seaboats.net - www.seaboats.net

65m Benetti



Listing ID - 4652

Description 65m Benetti

Date 2006

Launched

Length 64.8m (212ft 7in)

Beam 12.5m (41ft)

Draft 3.6m (11ft 9in)

Note Displacement: 1448.5T

Location Hong Kong

Broker Georgi Savchev

georgi.savchev@seaboatsbrokers.com

+359 88 7228674

Price €35,750,000

Ambrosia was one of the most famous yachts ever built by Benetti, commissioned by the shipyard's major shareholder, an experienced yacht owner, Mr. Ambrous Young who insisted that the best equipment was used throughout the construction.

The project was supervised by a team of international professionals including; Patton Marine, FORCE Technology, David Cannel and Associates (sound and vibration), CCS Paint Inspectors, Team Italia (navigation and communications) Ocean Independence (Mario Velona Yachts at the time), Nautilus Management and project management by Capt. Paul Brackley.

The build of Ambrosia was, at that time, the most complex yacht ever built in Italy engaging world leading experts for an owner with high expectation and unrivalled experience.

Builder: Benetti

65m Benetti - Francois Zuretti Interior

Delivered 2006

Built for main Shareholder of Azimut-Benetti

Class: LMC100A1SSCMonoG6 Yacht (P)UMS MCA

LOA: 64.8m

LWL: 58m

Beam: 12.5m

Draft: 3.6m

Displacement: 1448.5T

GT: 1639T

NT: 491t

Very high volume: 1639GT

Wide Beam: 12.6m

Helipad (not certified)

Never Chartered - light private use only - Built to MCA Large Yacht Code

5 year Special survey completed 2022, next Special Survey 2026

One owner since new

Bowthruster: Brunvoll 280kW (375hp) variable pitch

Principal Designers and Consultants

Interior Design: Francois Zuretti

Profile: Stefano Natucci

Naval Architecture: Espen Oino / Benetti

Construction: Azimut Benetti

Lighting Consultants: Aqualuce

Tank testing, hydrodynamics: FORCE, Danish Maritime Institute

Noise & Vibration consultants: Meccano, Van Cappellen

Owners Representatives / Project Management: Central Yacht; Captain Paul Brackley, Chief Engineer Brett Mitchell

Engine

Stabilizers: Very stable and comfortable - Quantum Zero Speed / 4 fin Stabilizers

Main Generators: Caterpillar power - 2x CAT 3512B DITA

Auxiliary Generators: 2x CAT 3508C DITA

Emergency Generator: Caterpillar 3304

Propulsion System: ABB Azipod - 2x 1070kw

Range up to 9000NM at 10.5Kts

Low engine hours - Main engines 5640/5512, Secondaries 9196/9640

Fuel Capacity: 190cu.mt

Fresh Water Capacity: 58 cu.mt

Maximum Speed: 15.1kt

Range at 12 knots: 5500 nautical miles

Range at 10.5 knots: 9000 nautical miles (equivalent to 5200 liter / 1374USG per day)

Shore Power Converter: Asea accepting 520-170v 40/70hz

Black / Grey water system: Jets

Fuel Purifier: Alfa Laval, Racor

Accommodation

Crew Accommodation: 21 in 11 en suite cabins plus large crew dining and crew mess areas

Guest Accommodation: 12 in 4 guest cabins, VIP and owners suite

Wheelchair + Nurse accessible Elevator

Medical Room and Massage/Beauty Room
Cinema / Panoramic saloon
Whirlpool with counter-current Generator
Piano Bar with Yamaha Grand Clavinova
One Asian style dining (14 seat) and one Western style dining (14 seat)
Air conditioning: Heinen Hop man twin duct system
Water Treatment: Heinen Hop man, Oktopus
Water Maker: Hydro mar 2 x 15000L per day

Hotel Services

Galley: 2 x Rational Combo ovens, 1 x Zanussi Combo oven, deep fryer, flat grill, 2 x 4 plate Electrolux hobs, salamander Zanussi, Carpigiani ice cream machine.
Pantry: 3 x Euro cave wine cellars, 5x Foster ice makers, 2 x Faema espresso machines
Fridges / Freezers : 3 x walk in cold rooms day fridges in galley and all pantries
Elevators: Food lift galley to lower and bottom deck, Trolley lift main deck to upper and sundeck
Powered exterior doors: Aljo

Navigation and Communication

ECDIS System: 2 x Furuno FEA-2307 chart plotters
Dynamic Positioning System: Kongsberg cPos
Circle scanning sonar: Furuno CH-250
Radars: Furuno IMO ARPA "Black Box" FAR-2837S, Furuno IMO ARPA "Black Box" FAR-2827
Gyrocompass: 2 x C Plath Navigat 2100 (fiber optic)
Magnetic Compass: C Plath Jupiter 1
Autopilot: 1 x C Plath, 1 x Kongsberg
Electromagnetic Log: C Plath Naviknot III
Wind and Weather: B&G
Searchlights: 2 x Sanshin
Horn: Kahlenberg
Intercom: Stento, Tecnel
Anti-Piracy: 1 x LRAD , 1 x Gyrolight non-lethal deterrent
Radio Telephone: Furuno FS-2570 with DSC
VHF Radio: 2 x Furuno FM-8700 with DSC, 2 x Sailor RT 4801
Satcom Inmarsat F77: 2 x Furuno Felcom 70
Satcom Inmarsat C: 2 x Furuno Felcom 15
Satcom: Iridium: 2 x Sailor SC4000
Airband VHF: 2 x ICOM IC-A 110
Weather fax: Furuno FAX-30 Blackbox
Navtex: Furuno NX-500
Telephone Exchange: Panasonic PABX TDA 200

Audio Visual

Entertaining System: Tower Systems, Linn, Crestron, Yamaha Clavinova Grand Piano
Satellite Television: Seatel 9497, C Ku Band with global decoders
Digital Video Server: Kaleidescope distributed in six areas
High Definition Stabilized: Current Corp, GyroCam Camera

Electric

Electrical Design: ABB Marine, 690v 400v 220v, 50hz

Watersports Equipment and Facilities

Limousine Tender: Vikal Custom 8.5m (27.9ft) GRP, Volvo KAMD300, duo prop

Multi-purpose tender: Tresco custom 7.5m (24.6ft) carbon fiber / Nomex / prepreg, Volvo KAMD300, Kamewa Jet

Jet skis: Kawasaki ultra 150, Kawasaki STX 15 with Smart Steer safety steering system

Garages, Cranes: Two garages aft for both tenders and jet skis, 1 ton capacity crane on foredeck for further jet skis / sailing dinghys etc.

Dive Gear: Bauer dive compressor and 4 sets scuba pro dive equipment

Swim Platform, Passarella, Boarding Ladders: Large platform opening in transom with shower and hydraulic swim ladder. SOGEIN, hydraulic Passarella and side boarding ladders with up/down and rotate motion.

Spa Pool: 3 cubic meter spa pool with counter current generator

Fishing Chair: Nautical Design "martin chair"

Safety

Vikal 8.5m Limousine covered, air-conditioned Tender

Tresco 7.5m Carbon Fiber custom fast open Tender

Fire Systems: Ultrafog Suppresion, Autronica Fire Alarm

Alarm and Security System: ABB

Other Supplies and Subcontractors

Paint: Boero primer and faring, Alwgrip / Awlcraft topcoat

Wood Work: Capuzzi Arredamenti, LegnoLine, Mobilart

Marble: Paillote

Chairs, Arm chairs, stools & Benches: Artistic Frame, Baker, Calligaris, David Edward, Holly Hunt, J.R Scott, Vitra

Masscheroni, Minotti, modern with Passion, Rudin, William Switzer, Xavier Gelineau

Sofas: Baker,First time, Flair, J.R. Scott, Minotti, Randolph & Hein, Rudin, Turri

Tables: Baker, Michael Berman Limited

Tromple l*oeil and glass: Turelli of Pisaetching

Teak decks and rails: Monleon

Carpets: Tai Ping























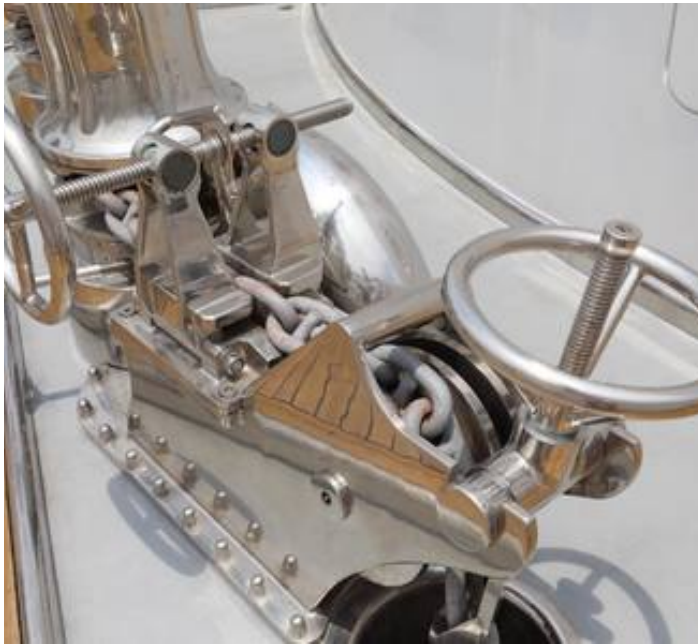

Ambrosia Video



3D Virtual Tour

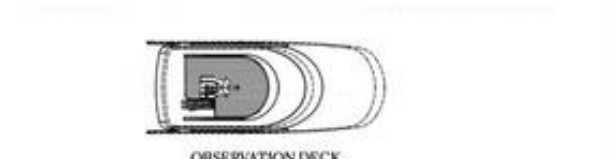

OBSERVATION DECK



MAIN DECK



SUN DECK

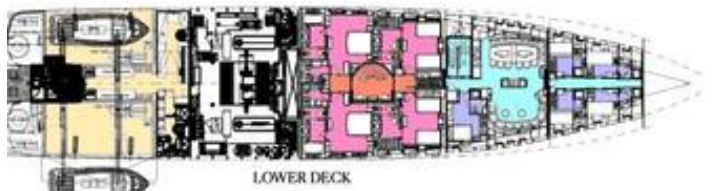

LOWER DECK



UPPER DECK

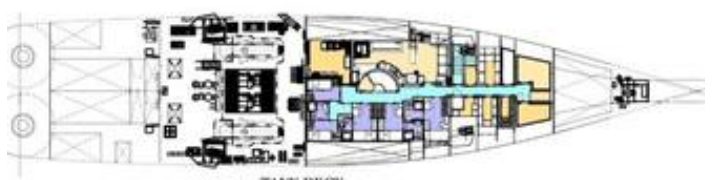

TANK DECK

The details of all vessels are offered in good faith but we cannot guarantee or warrant the accuracy of this information nor warrant the condition of the vessel. Any buyer should instruct their agents, or their surveyors, to investigate such details as the buyer desires validated. This vessel is offered subject to sale, price change, location or withdrawal without notice.



AUSTRALIA - BULGARIA - INDIA - INDONESIA - ITALY - MALAYSIA - NEW ZEALAND - PANAMA - PHILIPPINES - SINGAPORE - SPAIN - UK - USA - VENEZUELA - VIETNAM