



SEA BOATS

MARINE BROKERS WITH A GLOBAL APPROACH

AUSTRALIA - BULGARIA - INDIA - INDONESIA - ITALY - MALAYSIA - NEW ZEALAND - PANAMA - PHILIPPINES - SINGAPORE - SPAIN - UK - USA - VENEZUELA - VIETNAM

sales@seaboats.net - www.seaboats.net

NEW BUILD - 16m Sailing Catamaran



Listing ID - 4818

Description 16m Sailing Catamaran

Date Built to Order

Launched

Length 16m (52ft 9in)

Beam 7.70m (25ft 3.15in)

Draft 1.20m (3ft 11.2in)

Note 100 Hp 2x Volvo Penta D2-50 Hp

Location Cambodia

Broker Franklin Taylor

franklin.taylor@seaboatsbrokers.com

+64 27 276 5383

Price USD 910,000.

Dimension:

L (hull) : 16.000 m (52' 5.9")

LOD : 15.526 m (50' 11.2")

LWL : 15.980 m (52' 5.1")

Beam Overall : 7.700 m (25' 7.0")

Beam (Hull Centres) : 5.900 m (19' 4.3")

Draught (Canoe) : 0.658 m (2' 1.9")
Draught (Fixed Keel) : 1.200 m (3' 11.2")

Performance:

Displacement : 14700 kg (32408 lbs)
Power : 100 Hp 2x Volvo Penta D2-50Hp
Hull Speed under power : 10 Knots Approx
Air Draft : 23.03 m excludes aerials etc.
Sail Area Upwind : 154.5 m² (1663 sq ft)
Underwing Clearance : 845 mm (2' 9.29")

Capacity

Fuel Capacity : 860 litres (227 USG)
Fresh Water Capacity : 900 litres (238 USG)

Structural

Hull, Bulkheads, Main Deck, Superstructure constructed using certified (DNV or similar class) marine grade 5083 H116 aluminum.
Extrusions 6061 T6 with mill certificate. Welding wire to be 5183 with ABS certificate.
David DeVilliers design and CNC parts.
Propeller Shaft Stern Tubes
Rudder Shaft Tubes
Fully welded Thru hulls for S/W cooling and ancillary supply
Overboard discharges integral, welded.
Rudders and dagger boards per plan
Davit to launch and retrieve tender.

Mast and Rig

Seldon mast, boom, rigging, running rigging and halyards.
Seldon Headsail foils package.
Mainsail traveller system Deck Layout and Gear: 3 m radial track in forward cockpit with Lewmar or similar mainsheet traveller and 2 x 40ST self-tailing winches.
Primary winches 5 x 46ST. Mast winches 2 x 40ST. Halyards, outhaul etc are also handled at the base of the mast. Roller furling on jib.
Standard Ronstan or similar deck equipment fitted for jib and screecher furling.
Aluminum forward beam.
Aluminum pulpit and pushpit rails
Heavy Duty PVC Mesh (10mm squares) Trampoline

Sails

Mainsail Offshore Fully Batten
Measurements TBA : Area 97.75 m²
10 oz US Dacron Crosscut with Twin Ply Leech
Webbing on batten pockets both sides
3 reefs, flying foot, Overhead Leechline
PNP Batten Receptacles included
Battens and Battcars included
UV Cover Sunbrella

Furling Staysail Offshore

Measurements TBA : Area 32.57 m2

10 oz US Dacron Crosscut

UV Cover Sunbrella

Luff Foam

Furling Headsail Offshore

Measurements TBA : Area 70.5 m2

10 oz US Dacron Crosscut

UV Cover Sunbrella

Luff Foam

Asymmetric Spinnaker Offshore

Measurements TBA : Area 150 m2

1.5 oz Nylon FullRadial Cut

Spinnaker Sock included

3 Colours include

Hull Finishing

Primer- Epoxy- Maestria, 2 coats exterior only

Fairing Compound

Paint- Enamel, Maestria, 2 coats, yacht finish

Antifouling paint Jotun 2 coats

Zincs- Bolt on Type- 4 Minimum

Saloon Doors to Cockpit and aft deck - Weatherproof hinged

aluminum commercial door with window - Seamac

Windshields- 10 mm clear safety glass

Windows- tempered 6mm glass tinted each side and aft in Salon,

storm covers window screens on all opening windows in salon

Deck hatches built per plans or Lewmar or similar manufacture

Tanks, Piping & Pumps

Grey water Tank - 200 Gal aluminum

Sewage Tank - 60L aluminum

Fresh Water Tanks 2 - aluminum 500L Total

Diesel Fuel Tanks - 2 at 185L and 470L

Diesel Fuel Piping

Fresh water piping and fittings

Shore Water Supply Fitting

Salt Water piping PVC/drains

Through hull fittings – welded aluminum

Seacock Valves – Marelon

Sea Strainers

Tank Vents

Tank Fill Plate s/piping

Tank monitoring system BEP Marine

Hydraulic Steering Lines/helm pump, Seafirst

Bilge Pumping- Manual Amazon

Bilge pumps-electric with float switches and control panel, Jabsco

Salt Water washdown Pump, Jabsco

Shower Drain Pump with Float Switch, Rule
Fresh water Pressure Pump, Jabsco 38LPM, accumulator tank
Grey Water Discharge Pump with Y-Valve
Waste Macerator/Discharge Pump with Y-Valve
Waste Piping, low odor
Waste pump-out fitting

Mechanical

Propeller- 2 or 3 blade – Gori or similar folding x 2
Propeller Shaft Coupling x 2
Propeller Shaft- 38mm minimum 316 L standard SAE Taper x 2
Cutlass Bearings, Johnson x 2 sets
Dripless Shaft Seal, Duramax or Deep Sea x 2
Spur Line Cutter on Propeller Shafts
Main Diesel Propulsion 2 x FNM 30HPE 40HP @ 4,000rpm or Yanmar 40HP
Marine gear 2 x Hurth ZF or Technomarine
Main Engine Exhaust Pipes
Engine Space Ventilation Blowers - 1 inlet, 1 exhaust
Main Engine Mufflers - Halyard or similar
Parts Locker
Rudders - per plan
Rudder Stock- S/S 316L
Steering per plan
Battery Ventilation System
Engine Room Ventilation Ducts
Engine Room Soundproofing

Electrical

DC-AC Inverter/Charger-Victron 3000W
SOLAR PANELS - 8 Panels at 365W each. 2880 watts Mechanical
Engine Starting Battery- 2 x 100 Ah
House Batteries- 6 x 100Ah 12V LiFePO4 Deep Cycle Battery
Battery Boxes with Covers for all battery sets
Battery Switches
Power management system and battery monitoring, Victron or similar
50 Amp Shore Power Cord Reel,
Electrical Wiring- Tinned Copper- Marine
Grade- Ancor- color coded per ABYC
Electrical Panel 230/120 VAC / 12VDC with Ammeters & Voltmeters
Lighting System Wiring 12 VDC
Light Fixtures- Quartz Ceiling/LED
Light Fixtures- Fluorescent LED
Light Fixtures- Weatherproof LED
Light Fixtures- Courtesy LED
Light Fixtures- Reading Lights LED
Sockets 230/120 VAC in each cabin & Passageway
Sockets 12 VDC- Cockpit and Saloon
Light Switches- Wall type for cabin & exterior lighting
PVC Conduit for all power wiring
Radio/TV Wiring

Engine Alarm System

Electronics

Client supply

Main Deck Equipment

12VDC Windlass/Capstan with local control at Bow

Waterproof hatch for Dual Chain Locker

Bow Roller, Anchor 60lb CQR, chain 3/8" High Test, rope ."

Aluminum Bollard

Mooring cleats welded on, aluminum

Vents

Escape/Ventilation Hatch - Lewmar or similar

Handrails- Welded 32mm aluminum with 38mm Stanchions

H/C Fresh Water Cockpit Shower

Salt/Fresh Water Washdown Taps - Bow & Stern

Deck Filler Fresh Water- Port & Starboard

Deck Filler Diesel Fuel- Port & Starboard

Cockpit Equipment

Navigation. Anchor Lights

Red/Green Side lights

Mast head light

Flood lighting on mast

Engine Instrument Panel

Stainless Steel Destroyer type steering wheel

Engine Throttle/Transmission Controls- Cable, Morse, twin engine

Engine Tachometer – Digital / Analogue

Engine Water Temperature

Engine Oil Pressure

Engine Oil Temperature

Engine Ammeter

Engine Hour Meter

Compass- Binnacle Mount

Rudder Angle Indicator

Pilot's Seat

Passenger Seat

Dinette Seating /Storage

Pedestal Table

Gear Lockers

Access Ladder- aluminum

Air Horn with compressor

Rigging for Flags

Welded aluminum Railings

Interior Finish

Nidacore subfloor- painted

Composite or GRP lightweight panel for walls and ceilings

Solid timber – Trim

Floor coverings, laminated panel

Cork Flooring - Galley
GRP moldings for heads/bathroom
Interior Doors & quality hardware
Upholstery/Cushions

Galley

Refrigerator/freezer standalone 10 cu ft
Chest freezer
3-Burner ceramic cook top electric/gas
230/120 VAC Outlet, 4 gang
Convection/Microwave oven
Corian or other Galley Counter
Base Cabinets
Galley Overhead Cupboards
Stainless Steel Double Sink
Faucet with pull-out sprayer
Cutting Board

Saloon/Lounge

L-Shaped Dinette Table- Converts to Bed
Seating as per plan
Safety grab bars, fiddles placed at practical places
Radio/TV Outlet
230/120 VAC Outlet, 2 gang

Master Stateroom

Bed Frame- Queen size
Hanging lockers lined, with shelf & light
Bedside Table
Chest of drawers
230/120 VAC Outlet
Reading lights
Recessed Overhead LED lights with wall switch
Radio/TV Outlet

Aft Cabin [port and starboard]

Double bed
Hanging lockers- lined with shelf & light
Desk/drawer unit
230/120 VAC Outlet
Reading light
Recessed Overhead LED lights with wall switch
Radio/TV Outlet

Heads

Porcelain Electric head, Tecma [household size]
Shower
GRP Vanity with Corian or other countertop & S/S sink
Medicine Cabinet with Mirror & Storage
Ventilation Blower

Shower Faucet
Shower Head
Shower Curtain
Soap Dish / Toothbrush Holder
Towel Rod to Handrail Strength

Engine Room

Soundproofing
Perforated Stainless or Aluminum wall sheathing
Aluminum Checkerplate Flooring
Fluorescent lights with wall switch
230/120 VAC Outlet, 2 gang

Safety Equipment

Fire Extinguishers

Additional

Electrical and mechanical drawings plus vessel manual

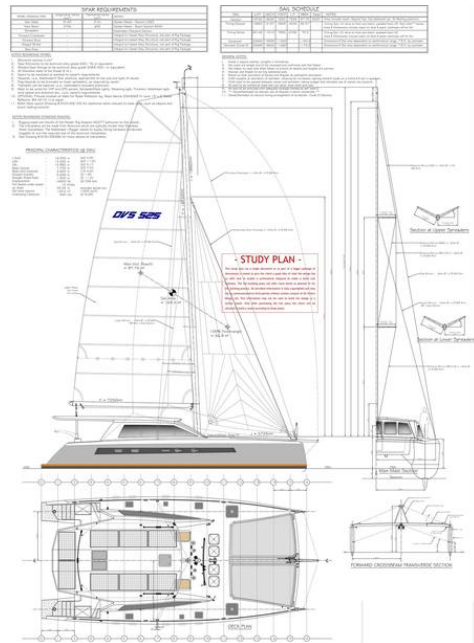
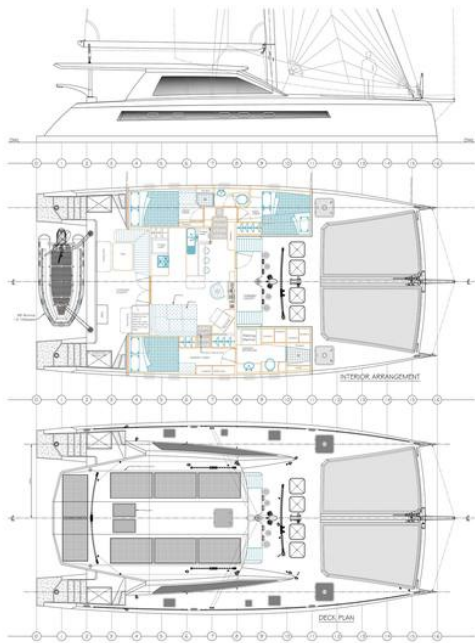

The details of all vessels are offered in good faith but we cannot guarantee or warrant the accuracy of this information nor warrant the condition of the vessel. Any buyer should instruct their agents, or their surveyors, to investigate such details as the buyer desires validated. This vessel is offered subject to sale, price change, location or withdrawal without notice.

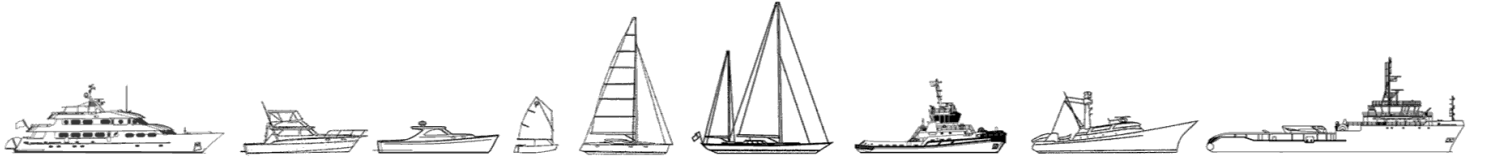

AUSTRALIA - BULGARIA - INDIA - INDONESIA - ITALY - MALAYSIA - NEW ZEALAND - PANAMA - PHILIPPINES - SINGAPORE - SPAIN - UK - USA - VENEZUELA - VIETNAM