



# SEABOATS

MARINE BROKERS WITH A GLOBAL APPROACH

AUSTRALIA - BULGARIA - INDIA - INDONESIA - ITALY - MALAYSIA - NEW ZEALAND - PANAMA - PHILIPPINES - SINGAPORE - SPAIN - UK - USA - VENEZUELA - VIETNAM

[sales@seaboats.net](mailto:sales@seaboats.net) - [www.seaboats.net](http://www.seaboats.net)

## Sunseeker Predator 130 - PRIVATE & CONFIDENTIAL



### Listing ID - 3011

Description	Sunseeker Predator 130
Date Launched	2012
Length	39.12m (128ft 4in)
Beam	8.10m (26ft 6in)
Location	Croatia
Broker	Richard Pierrepont <a href="mailto:richard.pierrepont@seaboatsbrokers.com">richard.pierrepont@seaboatsbrokers.com</a> +44 7798 607 323
Price	EUR 11.8 million

LOA: 39.12m  
BEAM: 8.10m  
HULL: GRP  
SPEED: 24 knots  
BUILDER: Sunseeker  
YEAR: 2012  
FLAG: Jersey  
GUESTS: 10 + 2

### MAIN CHARACTERISTICS

Builder: Sunseeker  
Year: 2012  
Flag: Jersey  
Classification MCA Large Yacht Code 2 Short Range EFP  
LOA: 39,12 m  
Beam: 8,10 m

Draft: 2,75 m

Hull: Composite

Engines: 2 x MTU 12V4000 M93 (3184 PS)

Engine hours: 1400 h (10 Oct 2016)

Range: 1500 nautical miles (10-12kn @ normal half load)

Generators: 2 x Kohler 80EFOZD 80kW 400/230V 3 phase 50Hz (European Specification)

Generator hours: PT 4500h, SB 4500h (10 Oct 2016)

Fuel Consumption: 950 l/h at cruising speed

1350 l/h at top speed

Fuel capacity: 26 800 l

Fresh water capacity: 4 950 l

Hot water capacity: 400 l

Grey water capacity: 1 350 l

Black water capacity: 1 450 l

Watermaker: 1 x Idromar MC3S (6000 litre capacity per 24 hours)

Fresh Water System: Flybridge high pressure water misting system installed on underside of radar arch (6 outlets)

Water softener for domestic water system (Kinetico CC206)

2 x 200 litre hot water cylinders

Stabilizers: Trac Star Digital fin stabiliser system (providing full roll control at speeds above 13 knots and significant roll reduction while at rest or anchor)

Thrusters: Bow Thruster - TRAC 20" 100hp hydraulic.

Stern thruster - 65hp hydraulic

Air condition: Air conditioning upgrade Tropical specification air

Air Conditioning Air Handler Upgrade to Quieter Running

Fuel system Fuel Cleaning Centrifuge (Single Unit) 'Alfa Laval'

Engine Control Systems Wing Station Controls on Port & Starboard Side

Portable Wondering Lead for the Engines and Thruster

Controls

## **ACCOMMODATION**

Owner Full beam Main Deck Stateroom with Balcony, dressing room, lounge area and office area en suite

Guests Optional full beam VIP Stateroom

Both Double Aft Cabin Staterooms have Folding Pullman berth

Crew Captain's Double Cabin with shower room en suite

2 x Twin Cabins with shower rooms en suite

## **ELECTRICAL SYSTEM**

- European, 230/400V 3 phase supply at 50 Hz
- Shore supply input via a single 100 Amp 3 phase connection and Atlas Shore power converter 90kVA
- Inlet provided with Glendinning Cable master. Cable length 20m
- All AV equipment powered through inverter

## **DECK EQUIPMENT**

Anchor Windlass Twin Muir VCR 8000 hydraulic vertical anchor windlass

Two 210 kg 'Manson' Galvanised anchors

Aft Warping Captans Two Muir VC6000 hydraulic capstans with ribbed type drums fitted on the port and starboard sides of the aft deck

Passarelle A self-stowing passerelle with 6.00 metre extension and 580mm wide is fitted with handrails.

Manufactured of Polished stainless steel with a laid teak walkway.

Swimming Platform Hydraulic Rise & Fall Bathing Platform

## **TEAK & DECK COVERINGS**

- Flybridge Teak Decking
- Teak Side Decks
- Teak Forepeak deck area
- Teak plinth around the aft end of the Fly bridge sunpad with drinks holders

## **FLYBRIDGE FEATURES**

Stargazer is provided with a Jacuzzi Hot Tub on the flybridge deck. Manufactured of GRP construction and be suitable for use whilst at anchor or alongside. The hot tub is an 8-10 jet air system with integrated L.E.D lighting and is controlled by pneumatic air switches mounted on the perimeter.

The Yacht is provided with a Wet Bar sited on the flybridge deck. Integrated into the bar be:-

- Ice maker with seperate charcoal filter
- Small sink & Tap with hot and cold water
- 100 Litre refrigerator.
- Griddle
- Small Storage Locker
- Stone finished surface
- Shallow raised glass bar top (with uplighting)
- 4 x Stainless steel bar stools (fixed)

## **BIMINIES, AWNINGS, PARASOL & CANOPIES**

- Retractable Electric Sun Awning for aft Flybridge to shade Spa Tub area
- Retractable Hydraulic Sun Awning for Flybridge overhang (shading Aft Cockpit)
- Foredeck Parasol "Tuuci - Zero Horizon, Ocean Master" with 2 x Deck Sockets. 1 x Socket in the middle of the U - Shaped Seating Teak Table and 1 x Deck Socket in the middle of the Sunlounger

## **SAFETY & LIFESAVING**

Fire Extinguisher's :

- 9 x 6 Kg Dry Powder Fire Extinguisher
- 6 x 9 Litre AFFF Foam Fire Extinguisher
- 1 x 2 Kg CO2 Fire Extinguisher
- 4 x 5 Kg CO2 Fire Extinguisher

Firefighting Equipment :

- 2 x Fireguard Fireman's Outfit
- 2 x Drager PA 91 Breathing Apparatus Set
- 2 x Drager Panorama Breathing Apparatus Mask
- 4 x Drager 6 Litre 200 Bar Steel Oxygen Cylinder's
- 2 x Wolf TR 24 ATEX Fireman's Torches
- 2 x Steel Cored Fireman's Safety Line
- 2 x Fireman's Axe
- 1 x Spare AFFF Solution
- Fire Blanket ( One per cooking area )

Pyrotechnics and Signalling Equipment :

- 4 x Hansson Ikaros Line Throwers including spare Rocket's and Ignitor's
- 6 x Hansson Ikaros Rocket Flares
- 2 x Hansson Ikaros M.O.B Smoke and Light Signals
- 1 x Flare Storage Canister
- 1x Stainless Steel Ship's Bell ( Can be engraved with Ship's name if specified )
- 1 x Anchor Ball, 30 cm Plastic
- 3 x Signalling Ball, Canvas

- 1 x Signalling Diamond, Canvas
- 1 x Waterproof Searchlight

#### Navigational and Communication Equipment :

- 1 x Simrad EP 50 EPIRB
- 2 x Simrad AX 50 GMDSS VHF Handset's including NICAD Batteries
- 2 x Simrad LITHIUM Batteries for AX 50 Handset
- 2 x Simrad Trickle Charger's for AX 50 Handset
- 1 x Simrad SA 50 SART
- 1 x Weem's and Plath Clock ( Chrome or Brass finish as specified )
- 1 x Weem's and Plath Barometer ( Chrome or Brass finish as specified )

#### Personal Protection Equipment :

- SOLAS approved Adult Automatic Lifejacket ( One per berth plus two additional )
- 2 x SOLAS approved Child's Lifejacket
- Wessex Immersion Suit ( One per Berth )
- Drager Parat C' Smoke Hood ( One per berth )

#### Liferaft Equipment :

- 4 x Zodiac 10 Person SOLAS B' Liferafts ( For more than 20 crew / passenger's a larger raft would be specified )
- 4 x Liferaft fixing assemblies including Chock's, Lashing Straps and Hydrostatic Release Units.

#### M.O.B and Rescue Equipment :

- 1 x Jason's Cradle including Lewmar block, tackle, fixings and 20 metre braided line
- 2 x 2 Kg SOLAS Lifebuoy's
- 2 x 4 Kg SOLAS Lifebuoy's
- 1 x Pilot Boarding Ladder
- 2 x Ocean Rescue Line

#### Publications and Notices :

- 2 x SOLAS No.1 Poster
- 1 x SOLAS Lifesaving Training Manual
- 1 x Fire Safety Operations Manual
- 1 x Fire Training Manual
- 1 x GMDSS VHF Card
- 1 x MARPOL Garbage Disposal Poster

#### Medical Equipment :

- 1 x Sunseeker Medical Kit ( Category A' minus prescription drugs )
- 1 x Oxygen Therapy Set
- 1 x Neil Robertson Stretcher

#### Miscellaneous Equipment :

- 1 x SOPEP Spill Kit
- 1 x RINA Fire Bucket
- 1 x Telescopic Ladder for mast access.
- 1 x Complete IMO Labelling Set.

#### **NAVIGATION EQUIPMENT**

- Furuno Network Sounder
- Transas - AIS
- Transas - ARPA

- Transas - Radar Integration
- Ultrasonic Wind System
- Flybridge Monitor upgraded to 2 x 15" Hatteland
- Wheelhouse Monitors upgraded to 3 x 19" Hatteland
- "M" Series Flir 626L Night Vision Camera linked into the Main Helm Navigation Display's
- Transas Navigation feed from the Main Wheelhouse to main saloon TV, Cockpit TV, fly TV and Upper & Lower Master State cabin TV's

#### Radar

Furuno X Band FAR2117 Black Box with 12kw, 6.5 feet open array antenna, ARPA ready, and keyboard control unit connected to 17" TFT display in Wheelhouse. Radar is repeated on a 15" Display at the Flybridge Helm.

#### Central Navigation Display

Sold state Marine PC controlling speed, depth and wind transducers, controlled via PS2 roller ball mouse connected to 17" TFT display in Wheelhouse. Airmar 744 Triducer shall be fitted for water speed and depth.

#### Chart Plotter

Rugged Marinised PC for chart plotting software, controlled via PS2 roller ball mouse connected to 17" TFT display in Wheelhouse. Chart Plotting software is repeated at the Flybridge helm on a 15" display with an I.P rated trackball for local control.

#### Auto Pilot

Simrad AP50 system, interfaced to Satellite Compass with display in Wheelhouse. A second Autopilot control shall be fitted at the Flybridge helm. Simrad RF45X Rudder reference shall also be fitted.

#### Compass

A Furuno SC50 Satellite Gyro Compass including antenna, processor unit is also fitted with a display in Wheelhouse. A Manual Ritchie compass is fitted at both helm positions.

#### GPS

Furuno GP150 12-channel GPS connected to Navigation PC and Radar

#### Searchlight

1 x 24V Sanshin remote searchlight with independent control located in the Wheelhouse.

#### Chronometer/Barometer

One off combined located in Wheelhouse.

#### Air Horn

One off 'Kahlenberg' D2 Air Horn with KA500 Air Compressor locally mounted.

1 x Spare magnetic compass bowl

### COMMUNICATION EQUIPMENT

KVH Tracvision HD11 Satellite TV System

1 x HD11 Stabilised Antenna dish in 51.3" radome

1 x Antenna Control Unit

1 x 30m Antenna power / data cable kit

KVH Tracphone V7 - Rack mountable configure

1 x V7 mini-VSAT in M11 Dome

1 x Control Unit

1 x Modem

1 x Ethernet Switch, 4-Port

Netgear 24-port Ethernet Switch  
Wireless Access Point  
Yachtspot WiFi Router

Brother Multi-function fax machine for Wheelhouse

Satellite System

One off Thrane & Thrane Fleet Broadband 250 phone system comprising of antenna, fixed handset and connected to onboard PABX telephone system.

Telephone System

Internal PABX telephone system, comprising fixed handsets in all guest cabins, saloon, wheelhouse, crew mess and galley. Two shoreline inputs shall be provided, 1 x Phone and 1 x Fax. Both of these shall be connected to the PABX.

Simrad RS87 DSC VHF system with 4 handsets. Separate GPS antenna connected to VHF.

2 x Approved Hand Held VHF Simrad AX50 GMDSS VHF Radio.

1 x Approved SART Simrad SA 50

Handsets located in the Wheelhouse, Crew Mess, Emergency Steering Position and Flybridge

Emergency Radio Beacon

Simrad EP50 float free EPIRB unit

1 x Loudhailer horn connected to the Simrad RS87

## **ALARMS & MONITORING**

- MPA Monitoring - ModBus Generator Control and Monitoring System, complete control and monitoring of generator parameters and alarms via MPA Touch Screen.
- MPA - Master Touchscreen in Crew Mess
- MPA - CCTV x 5 Camera's, 1 x Aft Facing for Docking purposes, 1 x Cockpit, 1 x Engine Room, 1 x Port Side Deck & 1 x Starboard Side Deck
- MPA Monitoring - SMS Paging facility allowing MPA alarms to be sent to up to five GSM accounts (line rental not included)
- MPA Monitoring - Swipe card security alarm system - Integrated to MPA
- MPA Monitoring - Yacht Exterior Access Point Monitoring Upgrade Additional system feature allowing immediate viewing of the state of all doors and hatches with warning alarms via MPA Touch Screen.

## **INTERIOR AND EXTERIOR LIGHTING**

Upper & Lower Master State Ensuites have Low Level LED lighting

Main Deck Saloon and dining area - Scene Control with dimming functionality.

Master Stateroom - Scene Control with dimming functionality

All other guest cabins, en-suites and common areas are locally switched.

Underwater Lights - Large Xenon 100mm (150w) 15 in Total (3 across transom and 6 on either side)

All External High and Low level deck Cantalupi LED lighting Dual White and Blue

Back lit Stainless Steel Signwriting

All exterior lighting is controlled via the MPA touchscreen from any terminal.

Navigation lights are provided, based on the International Regulations for the Prevention of Collision at Sea 1972 (IMO).

## **AV EQUIPMENT**

Flybridge

8 x SpeakerCraft AIM8-5 Speakers (Zoned from Main Saloon)

4 x Bose SA3 Amplifier

1 x Bose PMC II remote  
Drop Down 40" TV from Flybridge  
Future Automation Hardtop drop down Mechanism with Swivel  
Kaleidescape System Linked to TV

Main Deck Aft Cockpit  
6 x SpeakerCraft AIM8-5 Speakers (Zoned from Main Saloon)  
4 x Bose SA3 Amplifier  
1 x Bose PMC II remote  
Exterior 32" TV  
Kaleidescape System Linked to TV

Foredeck  
1 x Bose SA2 Amplifier  
2 x Marine speakers Bose 131 (Zoned from Main Saloon)  
1 x Bose PMC II remote

Main Deck Saloon  
55" LED 3D Television Samsung (UN55D7000) (Including 6 Pairs of 3D Glasses)  
Future Automation Rise & Fall Mechanism  
Bose 48 Lifestyle System  
Satellite Decoder with local control  
Kaleidescape System Linked to TV  
Samsung Blu-ray 3D DVD Player (BDC6900)

Master Stateroom  
40" LED 3D Television Samsung (UN40D7000)  
Bose 48 Lifestyle System  
Satellite Decoder with local control  
Kaleidescape System Linked to TV  
Samsung Blu-ray 3D DVD Player (BDC6900)

Lower Deck Full Beam Master Stateroom  
40" LED 3D Television Samsung (UN40D7000)  
Bose 48 Lifestyle System  
Satellite Decoder with local control  
Kaleidescape System Linked to TV  
Samsung Blu-ray 3D DVD Player (BDC6900)

Starboard Twin VIP Cabin  
32" LED Television Samsung (UE32D6100)  
Future Automation Rise & Fall Mechanism for TV  
Bose 321  
Kaleidescape System Linked to TV

Port Twin VIP Cabin  
32" LED Television Samsung (UE32D6100)  
Future Automation Rise & Fall Mechanism for TV  
Bose 321  
Kaleidescape System Linked to TV

Crew Mess

20" LED Television

1 x Car Type CD/DVD Player

1 x Pair Car Type Speakers

Crew Cabin 1

Car Type CD/Radio & 1 Pair Speakers

Crew Cabin 2

Car Type CD/Radio & 1 Pair Speakers

Captains Cabin

20" LED Television

1 x Car Type CD/DVD Player

1 x Pair Speakers

Wheelhouse

1 x Car Type CD Radio with two speakers

## **ENTERTAINMENT EQUIPMENT**

Satellite Television System

KVH M7 with two satellite decoders. One decoder will be located in the Main Deck Saloon and a second decoder fitted in the Master Stateroom. The Main Deck Saloon satellite decoder fed to the Lower Guest televisions without control.

Entertainment System

A Surround-Sound Home Entertainment system integrated through the upper deck and main deck saloons.

Flybridge

3 x Pairs Marine speakers (Zoned from Main Saloon)

3 x Bose SA2 Amplifier

1 x Bose PMC II remote

Main Deck Aft Cockpit

3 x Pairs Marine Speakers (Zoned from Main Saloon)

3 x Bose SA2 Amplifier

1 x Bose PMC II remote

Wheelhouse Deck

2 x Pairs Marine Speakers (Zoned from Main Saloon)

2 x Bose SA2 Amplifier

1 x Bose PMC II remote

Main Deck Saloon

50" LCD Television

Bose 38 Lifestyle System

Satellite Decoder with local control

Master Stateroom

40" LCD Television

Bose 28 Lifestyle System

Satellite Decoder with local control



Starboard Guest Double Stateroom

32" LCD Television

Bose 321

Port Guest Double Stateroom

32" LCD Television

Bose 321

Starboard Twin Guest Cabin

26" LCD Television

Bose 321

Port Twin Guest Cabin

26" LCD Television

Bose 321

Crew Mess

20" LCD Television

1 x Car Type CD/DVD Player

1 x Pair Car Type Speakers

### **WHITE GOODS**

Galley and Servery appliances

2 x Full height refrigerators (390 Litre each)

1 x Full height freezer (261 Litre)

1 x Dishwasher\*

1 x 600mm Oven\*

1 x Microwave\*

3 x 2 burner hobs

1 x Extractor\*

1 x Coffee maker\* (free-standing)

1 x Full height Sub Zero 427 Wine Cooler

1 x Icemaker

Crew appliances

1 x Undercounter Refrigerator\* (150 Litre)

1 x Slimline dishwasher\*

1 x Microwave

Flybridge appliances

1 x Refrigerator (100 litre)

1 x Icemaker

1 x Griddle

Guest Accommodation appliances

1 x Mini-bar – Master Stateroom

1 x Fridge - Lower Forward full beam Master Stateroom

Stern Laundry appliances

1 x Miele Professional Washing Machine & Tumble Dryer & Dishwasher

1 x Additional Professional Washing Machine

### **TENDER AND TOYS**

- Tender Williams 445 Turbojet
- Seadoo 300 GTX 3 seater
- 2 x Seabob 5

### **COMMENTS**

New to the Market, this 2012 Sunseeker 130 Predator is an excellent example of one of Sunseeker's most prolific Sport flybridge models. Built and delivered in 2012, "Stargazer" is a one owner yacht from new and maintained to a meticulous standard. With accommodation for up to 10 guests, Ken Freivokn complete Interior Design, 3 balconies and incredible list of additional options, "Stargazer" is and ideal yacht to entertain family and friends

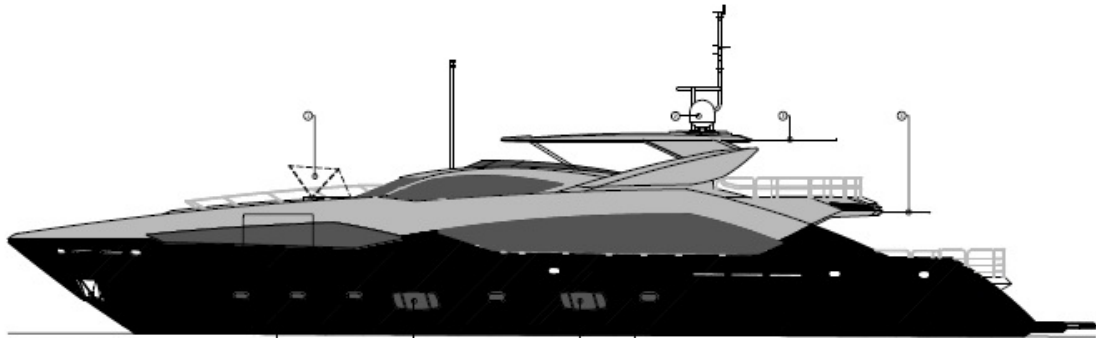

PROFILE OPTION 3  
 Show elevation with the superstructure

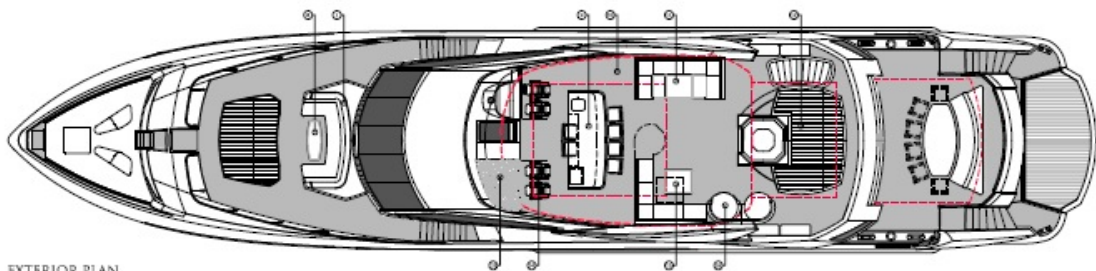

EXTERIOR PLAN

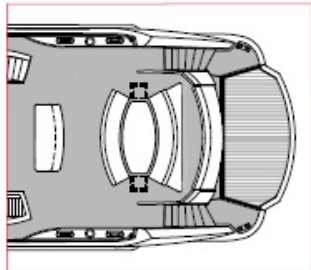
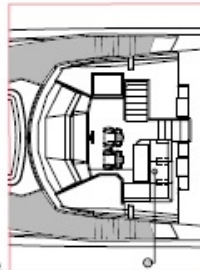

MAIN DECK COCKPIT OPTION  
 Show also the seating arrangement for the  
 flybridge and the swim platform

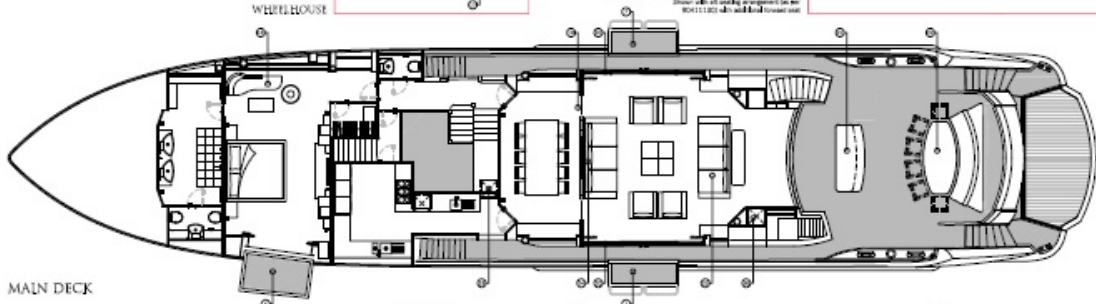

MAIN DECK



LOWER DECK

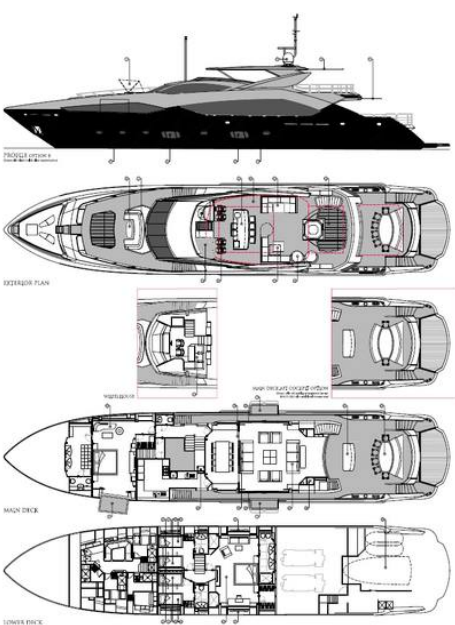







The details of all vessels are offered in good faith but we cannot guarantee or warrant the accuracy of this information nor warrant the condition of the vessel. Any buyer should instruct their agents, or their surveyors, to investigate such details as the buyer desires validated. This vessel is offered subject to sale, price change, location or withdrawal without notice.

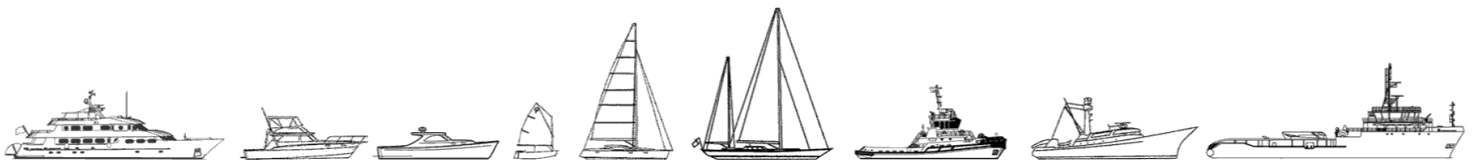

AUSTRALIA - BULGARIA - INDIA - INDONESIA - ITALY - MALAYSIA - NEW ZEALAND - PANAMA - PHILIPPINES - SINGAPORE - SPAIN - UK - USA - VENEZUELA - VIETNAM