



SEABOATS

MARINE BROKERS WITH A GLOBAL APPROACH

AUSTRALIA - BULGARIA - INDIA - INDONESIA - ITALY - MALAYSIA - NEW ZEALAND - PANAMA - PHILIPPINES - SINGAPORE - SPAIN - UK - USA - VENEZUELA - VIETNAM

sales@seaboats.net - www.seaboats.net

NEW BUILD - 19.8m Commercial Fishing Vessel .



Listing ID - 1260

Description 19.8m Commercial Fishing Vessel

Date Launched Built to Order, build time is 5-6 months.

Length 19.80m (64ft 11 in)

Beam 4.40m (14ft 5in)

Draft 0.85m (2ft 9in)

Note 20t

Location ex factory, China

Broker Franklin Taylor
franklin.taylor@seaboatsbrokers.com
+64 27 276 5383

Price USD 420,000 ex factory

The 19.8m fishing boat built in Xiamen, China, is a 100% hand-laid solid fiberglass hull. During the lamination of this vessel, vinyl ester resin was used in the outer layers for superior blister resistance. She is constructed with knitted bi-axial fiberglass cloth throughout lamination for added impact resistance. Additional hull reinforcement has been added at the bottom, turn of bilge, and bow sections and Ashland Max Guard brand ISO-NPG gelcoat was used for long-lasting shine and durability. These are just some of the quality processes and materials used in the construction of this 19.8m commercial fishing boat.

Main Specification

Loa:19.80m

Beam : 4.40m

Depth : 2.50m
Draft : 0.85m
Power :600hp*2. Twin Engine
Speed : 26kn
Displacement : 20t

FRP Hull And Deck

- 1.100% Hand-laid Solid Fiberglass Hull Lamination
- 2.Vinylester Resin In Outer Layers For Superior Blister Resistance
- 3.Knitted Bi-axial Fiberglass Cloth Throughout Lamination For Added Impact Resistance
- 4.Additional Hull Reinforcement In Bottom, Turn Of Bilge, And Bow Sections
- 5.Ashland Max Guard Brand Iso-npg Gelcoat For Long Lasting Shine And Durability

Twin 600hp Engines: 2
Hca302 1.5:1: 2
30kw Generator
Hydraulic Steering

Electric Pump
Bilge Pump
Bilge Pump Alarm
Fresh Water Pump
Engine Room Ventilation
Ceiling Lamp
Engine Room Light
Navigation Lights
Mast Light
Stern Light
Anchor Light
Red Allround Light
Vhf Dsc
406mhz
Gps
Compass
Ventilation For Cabin Room
Electromagnetic Oven
Steering Control
Side Power
Hatches
Electric Head
Ventilation Machine
Captain Chair
Rain Wiper
Ac/Dc Switch Board
Zinc
Generator
Air Condition
Charger
Fresh Water System
Port Power

Deck Washing
Hot Water
Warm Air
Cross Bar
Anchor
Anchor Frame: 3
Stern Platform
Stern Door
Electric Anchor Machine
Fishing Tank
Carpet
Forward Cabin Hatch
Side Hatch
Cushion
Hand Rail
Sliding Door
(Hr1170) Searching Light
(Es15/Es175 Horn
Ice Box
Dc-to-ac Converter
Navigation Lights
Battery
Certificate
Life Raft
Radar System

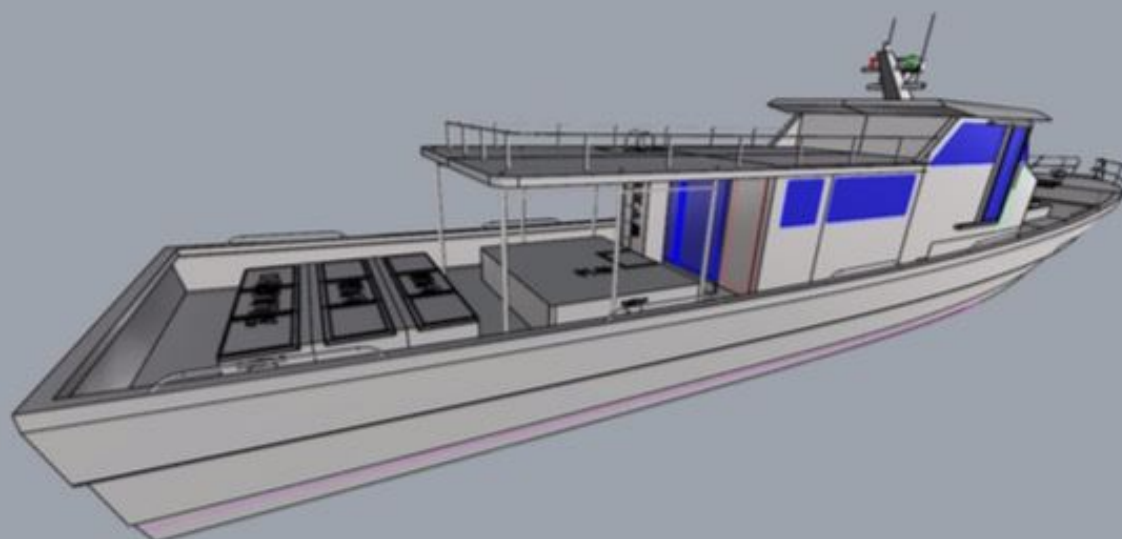



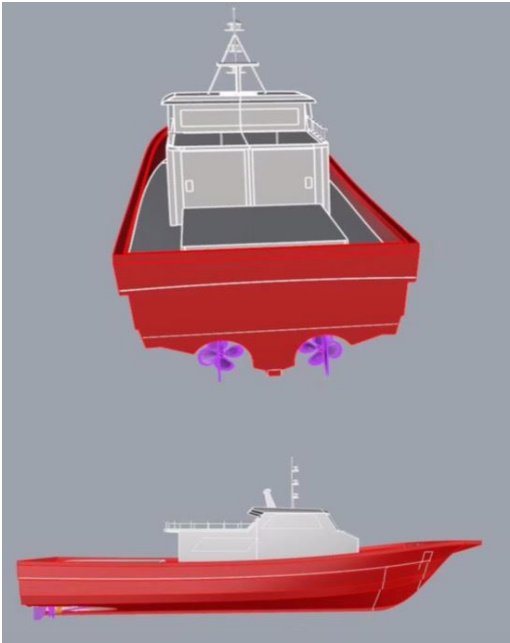
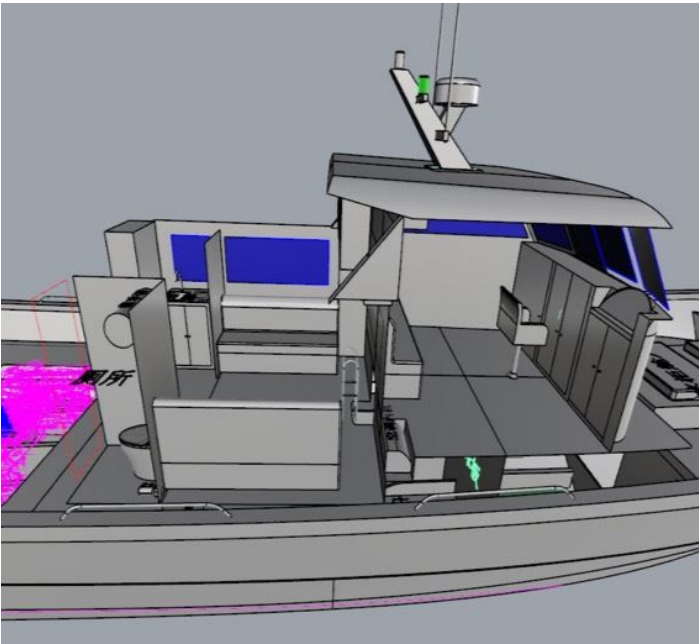



The details of all vessels are offered in good faith but we cannot guarantee or warrant the accuracy of this information nor warrant the condition of the vessel. Any buyer should instruct their agents, or their surveyors, to investigate such details as the buyer desires validated. This vessel is offered subject to sale, price change, location or withdrawal without notice.



AUSTRALIA - BULGARIA - INDIA - INDONESIA - ITALY - MALAYSIA - NEW ZEALAND - PANAMA - PHILIPPINES - SINGAPORE - SPAIN - UK - USA - VENEZUELA - VIETNAM